



UAN: 111-203-203

Email: sales@interwoodmotel.com

interwood.pk | corporate.interwood.pk

Instagram /interwoodmotel Instagram /interwoodcorporate

For corporate queries email:

corporate@interwoodmotel.com

## SHOWROOMS

### Islamabad/ Rawalpindi

- DHA Islamabad Showroom  
Main GT Road, Opposite Gate 4,  
DHA Phase 2,  
Islamabad, 45710
- I-9 Showroom  
Plot # 390, Street No. 16,  
Potohar Road  
(Near I-9 Police Station),  
I-9/3, Islamabad,  
Islamabad Capital Territory, 45710

### Lahore

- Garden Town Showroom  
7, Babar Block  
New Garden Town, Lahore,  
Punjab, 54600

### Karachi

- DHA Bukhari Showroom  
Building No. 43-C,  
Bukhari Lane No. 11, Bukhari Commercial Area,  
Phase 6 DHA, Karachi, Sindh, 74600

CERTIFIED BY:



YAGREEN 111-927-336

May, 2025

# KITCHENS

## CATALOGUE

## 2025

EDITION-1





# CHAIRMAN'S MESSAGE

Interwood is today a household brand name that is synonymous with high-quality international standard furniture, including home & office furniture, kitchens, doors, wardrobes, flooring, accessories and so much more. In addition to catering to homes, however, we also lend our brand of ready-made and customized furnishing solutions to hospitals, educational institutions, banks, corporations, hotels, luxury residences, retail brands and mega infrastructural projects like international airports. We are humbled by our achievements and are grateful to our partners, our competitors and of course our customers in helping us reach to where we are today. We remain ever-committed to continue evolving and delivering high-quality and affordable products to our customers.

## PURPOSE

To inspire everyone for a better lifestyle.

## VISION

Becoming the global lifestyle trendsetter, loved by all at home and at the workplace.

## OUR VALUES

Love for Customers  
Service | Respect | Agility

Re-Imagine  
Growth | Innovation | Automation

Transparency  
Honesty | Openness | Accountability

Collaboration  
Connection | Empowerment





### Our Manufacturing Facility, Lahore

Interwood's state-of-the-art manufacturing facility spans 600,000 sqft. and is equipped with over 300 of Europe's modern machines including fully-automated technology that is capable of processing a variety of different components for various products ensuring maximum efficiency and flexibility in production.





At Interwood Mobel Pvt. Ltd. quality is an integral part of our core business values. We are committed to delivering the top-most quality products, conforming to the highest international standards.

Our effective and efficient Quality Management System is based on the requirements of ISO 9001:2015. Our commitment to excellence is based on continual improvement in design, technology, materials and human resource development.



Ever since its inception in 1974, Interwood has directed its efforts in developing better interiors for homes and corporate establishments. It is our constant endeavor to raise standards in design, quality, durability, and innovation – the only aspect we ever lower, is the price. Our designers think differently, they understand the varied moods, colours, and temperaments. All our products are designed with only one thing in mind – You!





# INDEX



Minimal 01



Soho 07



Vogue 15



Brooklyn 21



Dialogue & Arctic 29



Hazel 37



Opera 51



Claire 27



Free 29



Arroyo 35



Iris 41



Imperial 49



Dusk 53



Moreno 55



Dune 59



Jude 59



Ellot 59



Kitchen Accessories 61



Kitchen Appliances 65



Worktops 76



Handles 77



LED Lights 78



Cabinetry 79



# MINIMAL

THE BEAUTY OF SIMPLICITY



If you love originality and measured elegance, then minimal is the kitchen for you, designed to make your time in the kitchen a real pleasure.





# PALETTE



KENDAL OAK  
18 mm



GREY  
18 mm

**BASE UNITS**  
carcass: off-white  
fronts: kendal oak  
handle: less profile  
worktop: carbon aggregate

**TALL UNITS**  
carcass: grey  
fronts: grey  
base: grey  
handle: less profile



# AVAILABLE IN

## LAMINATES

## GLASS



GREY  
18 mm



ALAND PINE  
18 mm



KENDAL OAK  
18 mm



KANSAS OAK  
18 mm



TOBACCO OAK  
18 mm



BAJRI GLASS IN PROFILE  
4/20 mm





# SOHO

A METROPOLITAN KITCHEN







Designed in the spirit of the Loft Style and inspired by an urban mood. Soho is a fusion of different materials that gives the kitchen its metropolitan core and appeal.







# PALETTE



ALAND PINE  
18 mm



INDUSTRIAL GLASS  
IN PROFILE  
4/18 mm

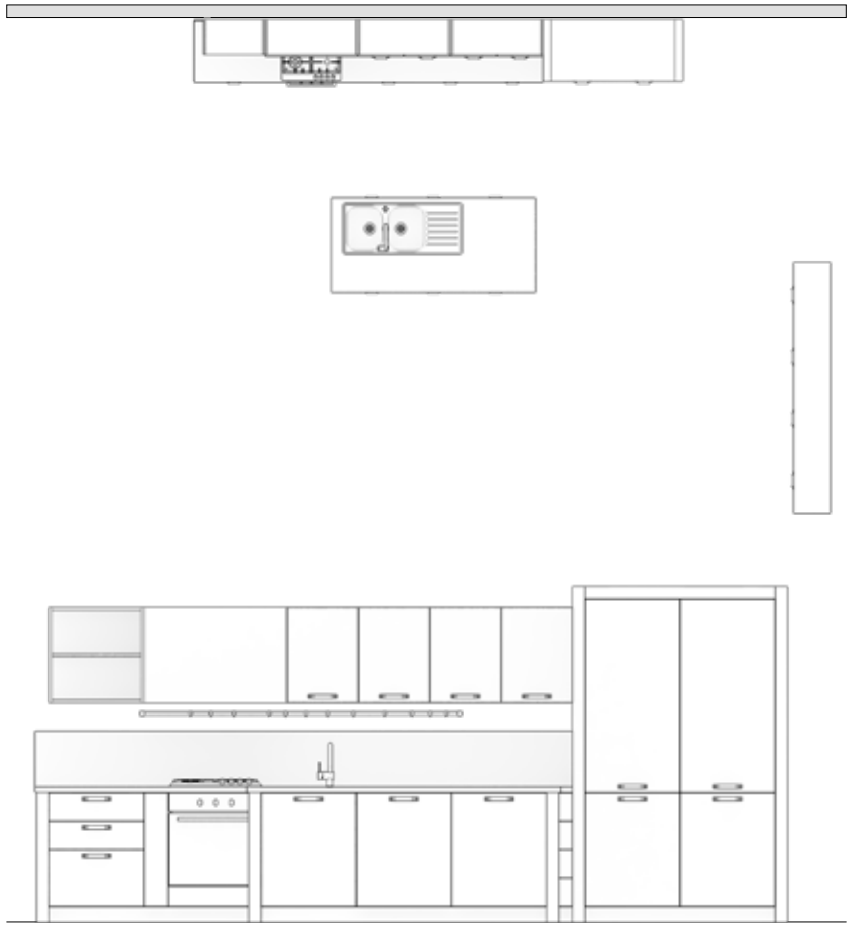

**BASE & TALL UNITS**  
carcass: off-white  
fronts: alandpine  
pull handle  
worktop: carbon aggregate

**WALL UNITS**  
carcass: off-white  
fronts: white & industrial glass  
base: open shelves in white & alandpine

# AVAILABLE IN

## LAMINATES



GREY  
18 mm



ALAND PINE  
18 mm



KENDAL OAK  
18 mm



KANSAS OAK  
18 mm



TOBACCO OAK  
18 mm



INDUSTRIAL GLASS  
IN PROFILE  
4/18 mm

## GLASS





# VOGUE

## AN OUTSTANDING BALANCE OF FINISHES

A kitchen with well-defined proportions, minimalist contours, and sophisticated range of finishes. Everything one needs in a perfect kitchen.







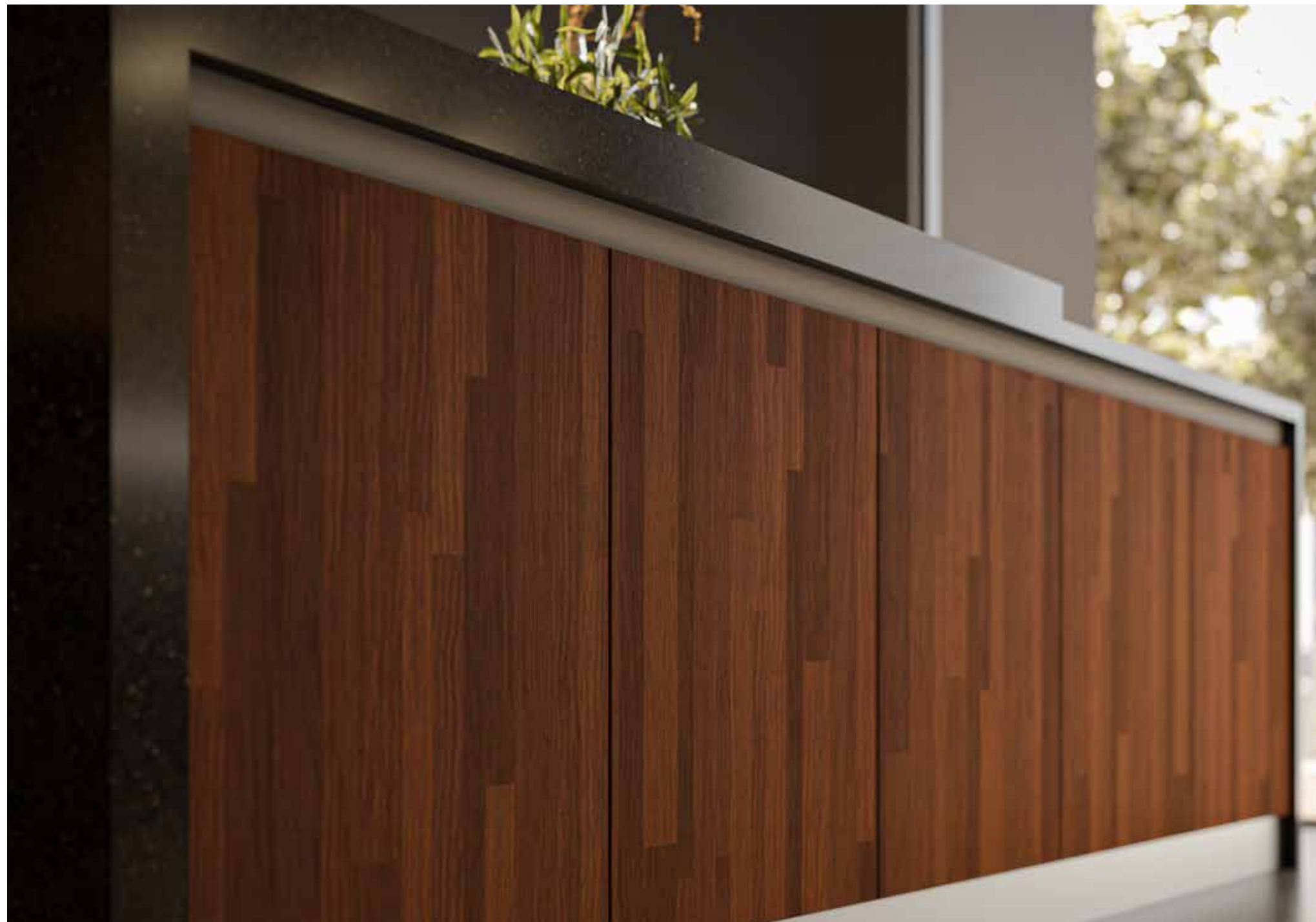
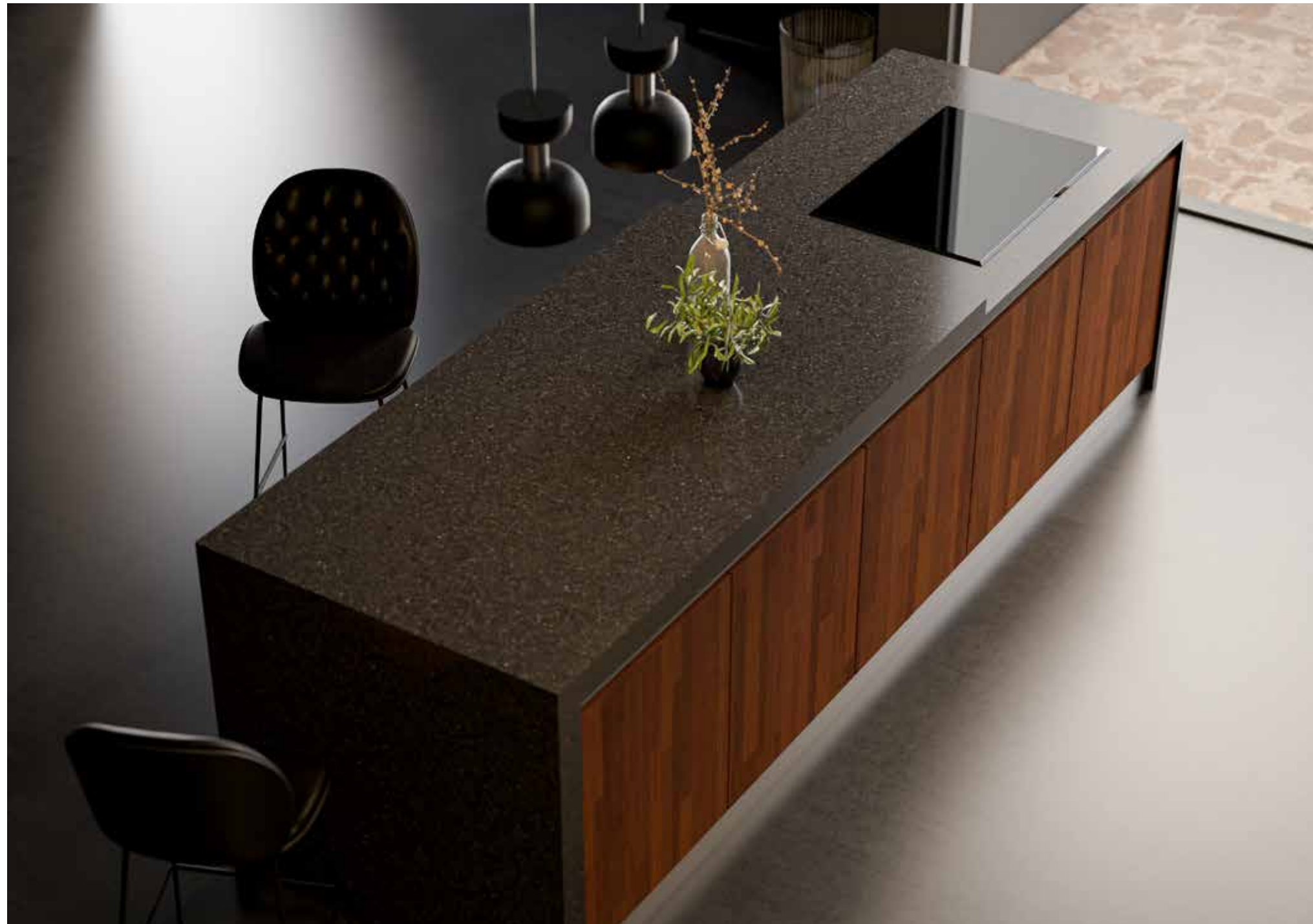



PALETTE



NATURAL WALNUT  
18 mm



ONYX GREY  
18 mm

— BASE, WALL & TALL UNITS  
carcass: grey  
fronts: natural walnut & onyx grey  
handle less profile  
worktop: carbon aggregate

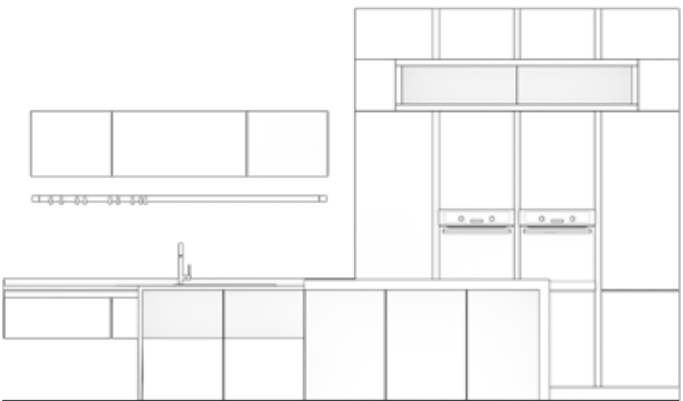

AVAILABLE IN

MATT PAINT



WHITE  
18 mm

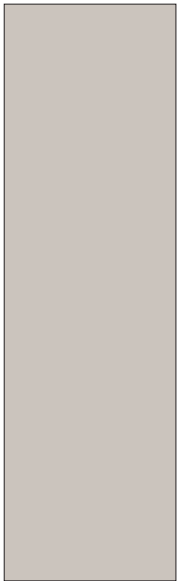

WARM GREY 2C  
18 mm

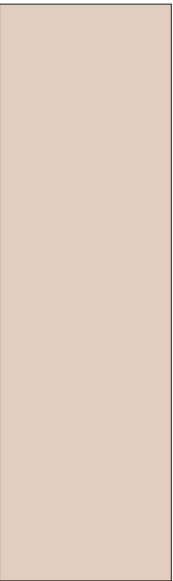

WARM GREY 6C  
18 mm



ONYX GREY  
18 mm

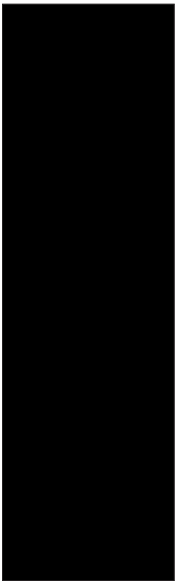

BLACK  
18 mm

LAMINATE



KERALA CONCRETE  
17 mm

VENEER



NATURAL WALNUT  
18 mm

GLASS



BAJRI GLASS IN PROFILE  
4/20 mm





## BROOKLYN

INDUSTRIAL DESIGN FINDS A NEW BALANCE







The Brooklyn kitchen is a link between the classic allure of yesterday and the innovative look of today. This elegant kitchen features a distinctive industrial style enhanced by attention to detail.





# PALETTE

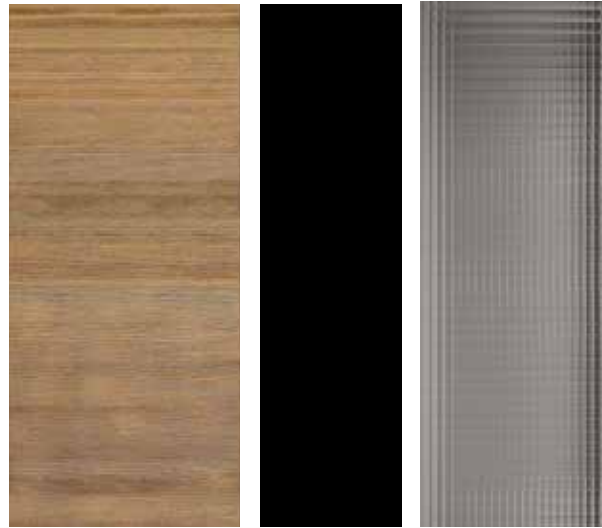

BRUSHED OAK NATURAL  
25 mm

BLACK  
25 mm

INDUSTRIAL GLASS  
4/25 mm

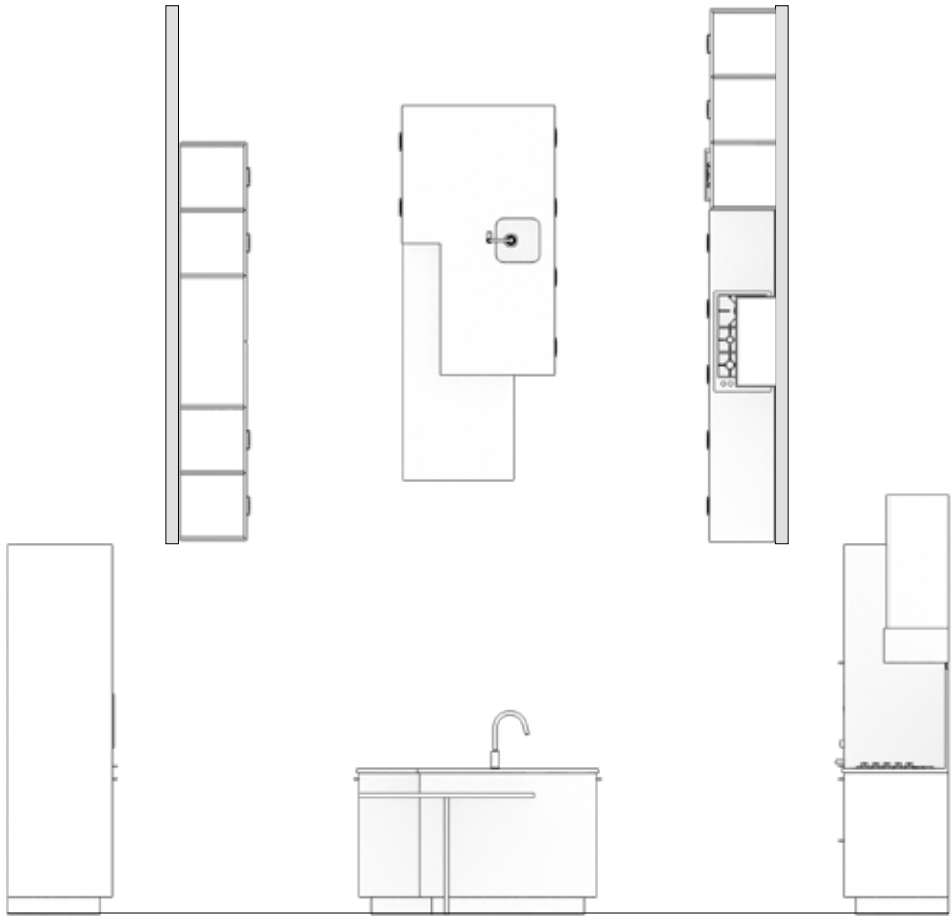

**BASE UNITS**  
carcass: grey  
fronts: brushed oak natural  
pull handle  
worktop: carbon aggregate

**TALL UNITS**  
carcass: grey  
fronts: black paint  
glass: industrial

# AVAILABLE IN

## MATT PAINTS

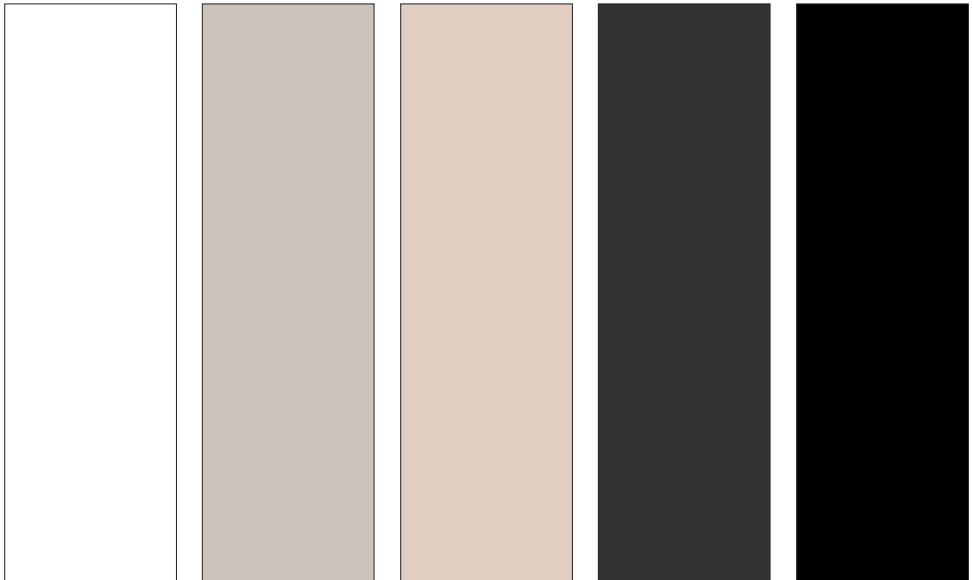

WHITE  
25 mm

WARM GREY 2C  
25 mm

WARM GREY 6C  
25 mm

ONYX GREY  
25 mm

BLACK  
25 mm

## WOOD CLADDING



BRUSHED OAK NATURAL  
25 mm

BRUSHED OAK SMOKE  
25 mm

## GLASS



INDUSTRIAL GLASS  
4/25 mm





## DIALOGUE & ARCTIC

ESSENTIAL LINES AND A CONTEMPORARY SOUL





From sleek cabinetry to sophisticated color schemes, this contemporary kitchen blends modern design with minimal aesthetics to create a distinctive look that transcends trends.



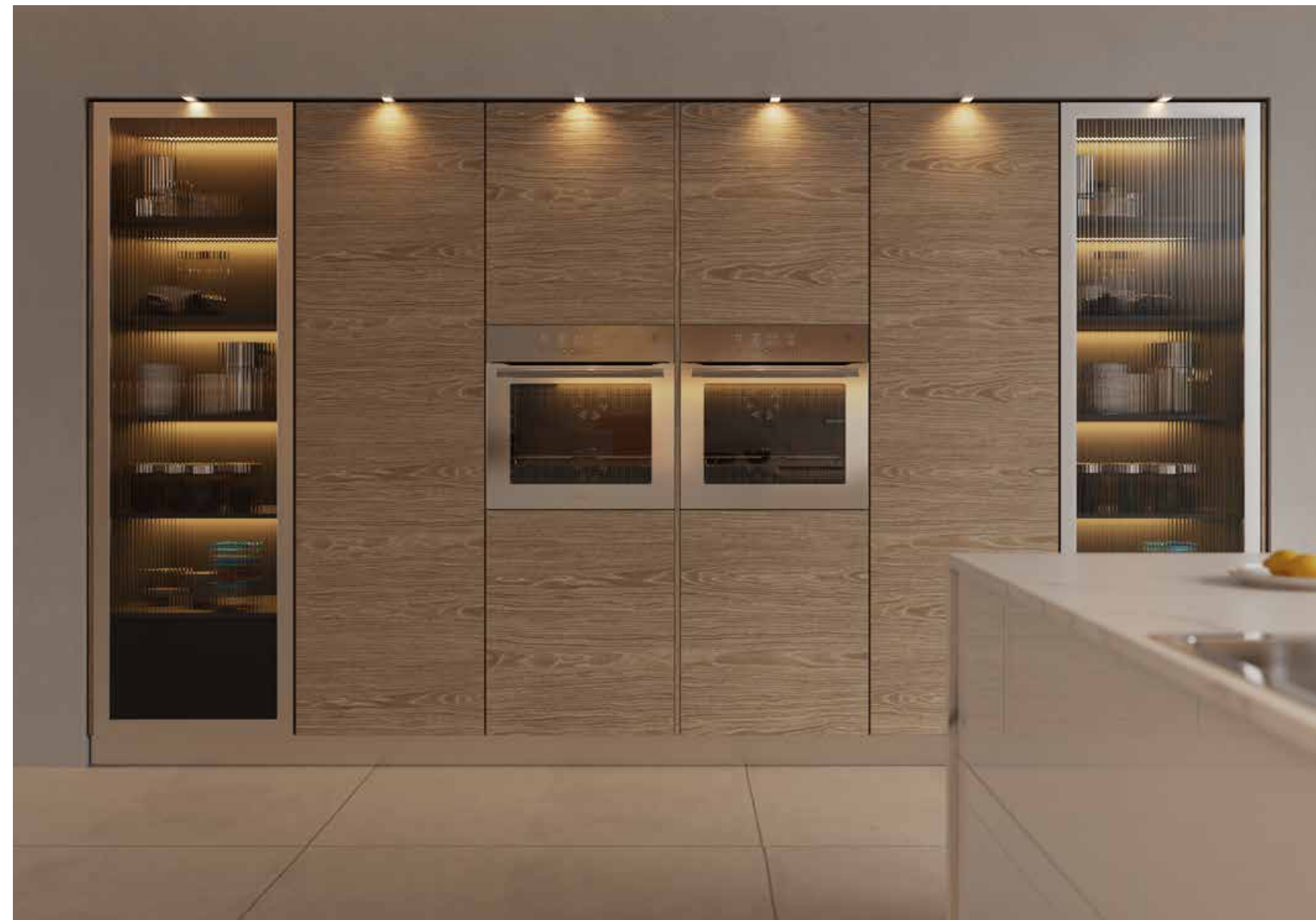

PALETTE



APRICOT  
18 mm

WHITE  
18 mm

FLUTED GLASS  
4/21 mm

— **BASE & WALL UNITS**  
carcass: off-white  
fronts: white painted  
glass: fluted  
worktop: aura  
push to open

— **TALL UNITS**  
carcass: grey  
fronts: wenge veneer

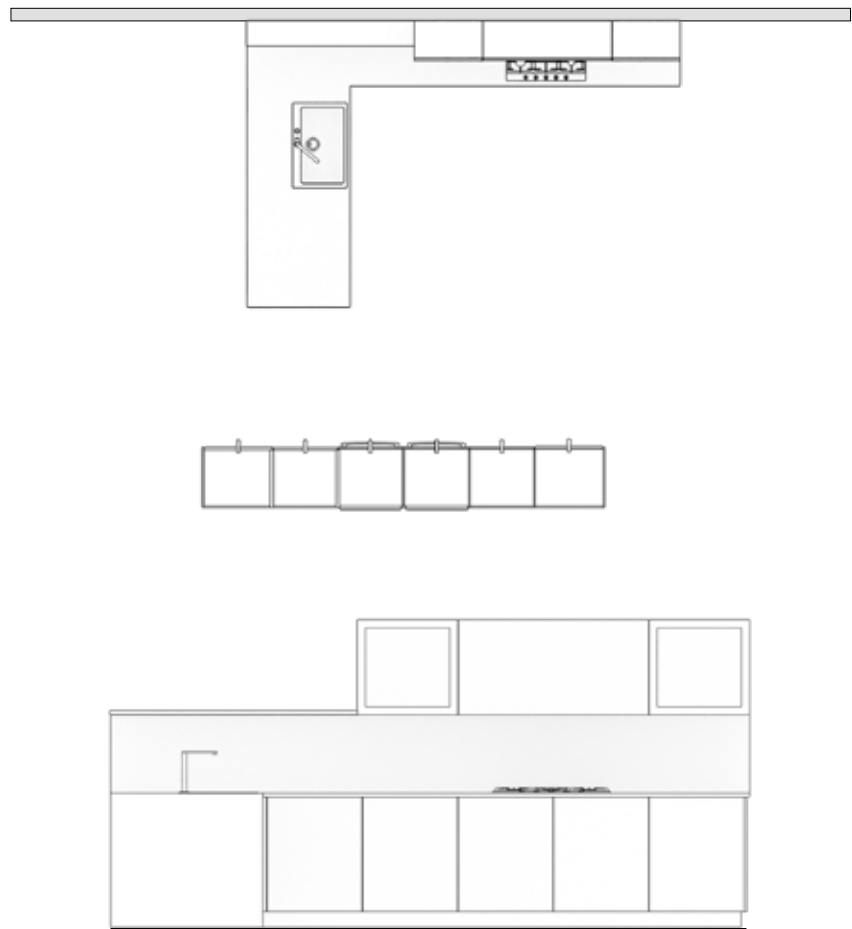

AVAILABLE IN

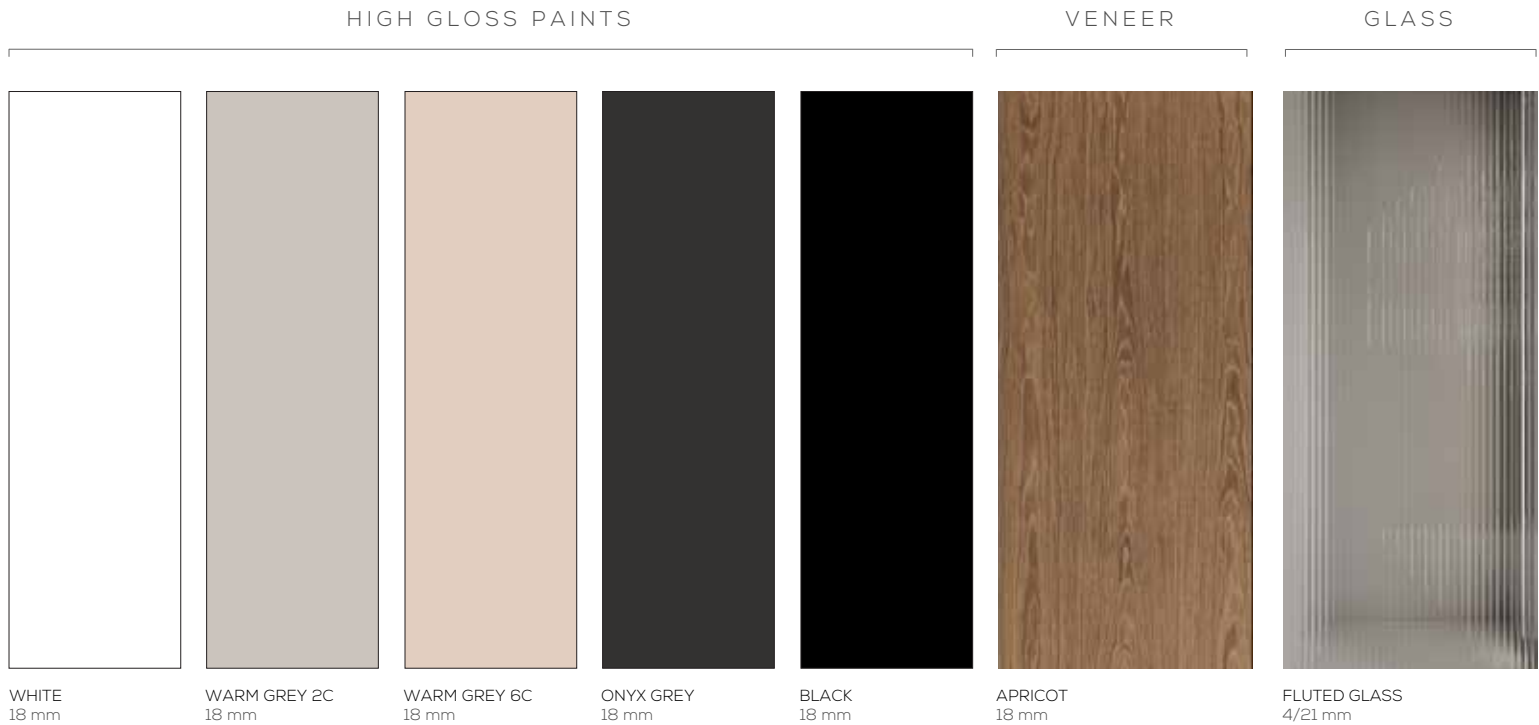





# HAZEL

## AN OUTSTANDING BALANCE OF FINISHES

A kitchen that extends intelligently, surprising you not only with its eye-catching design but also with the sophistication and quality of its materials.





PALETTE

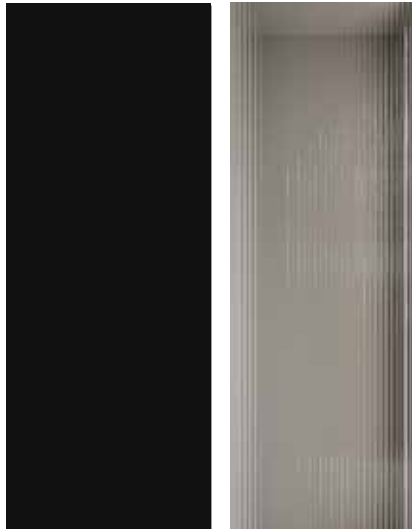

BLACK  
18 mm

FLUTED GLASS  
18 mm

— **BASE, WALL & TALL UNITS**  
carcass: grey  
fronts: black painted  
glass: fluted  
worktop: kelya  
handle less profile



AVAILABLE IN

HIGH GLOSS PAINTS

GLASS

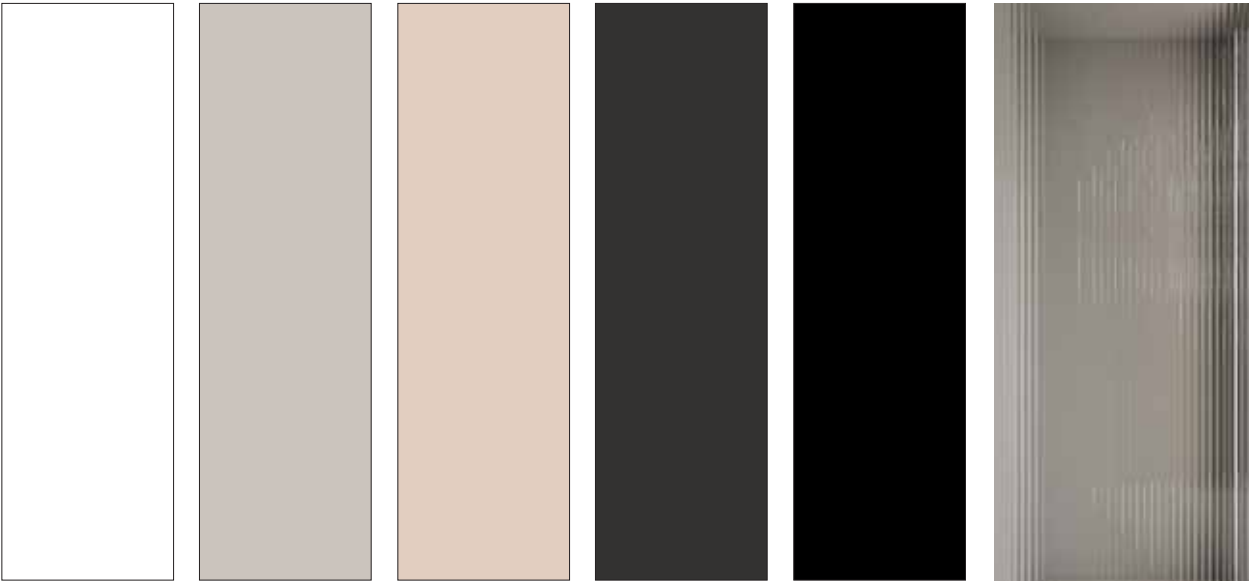

WHITE  
18 mm

WARM GREY 2C  
18 mm

WARM GREY 6C  
18 mm

ONYX GREY  
18 mm

BLACK  
18 mm

FLUTED GLASS  
4/21 mm



# CLAIRE

NEW CLASSIC FOR A CONTEMPORARY HOME







Claire presents a sophisticated appeal and love for tradition in a kitchen that blends the fascination of the past with an elegant contemporary soul of today.







PALETTE



JACOBEAN  
22 mm



ANTIQUE WHITE  
5/22 mm



GOLDEN ANTIQUE MIRROR  
5/22 mm

— **BASE, WALL & TALL UNITS**  
carcass: off-white  
fronts: jacobean & antique white  
pull handle  
golden antique mirror

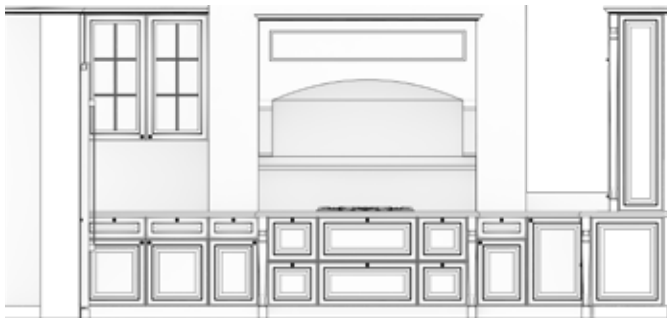
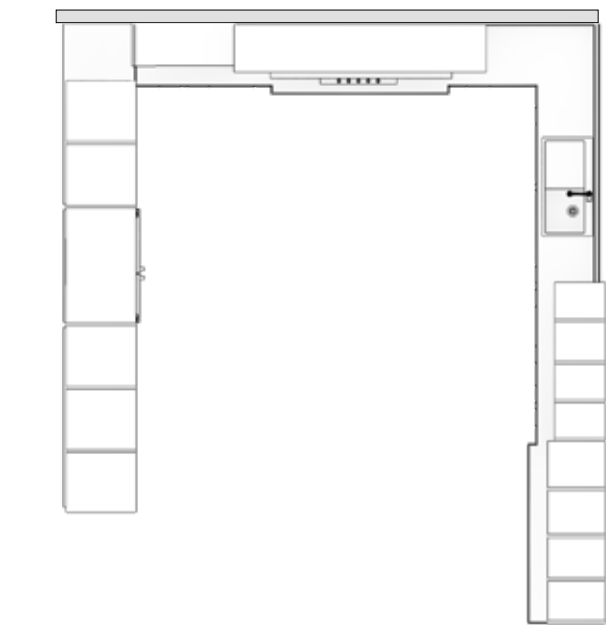

AVAILABLE IN

— VENEER/POLISH —



ANTIQUE WHITE  
22 mm



JACOBEAN  
22 mm

— GLASS —



GOLDEN ANTIQUE MIRROR  
5/22 mm



# OPERA

THE ABSOLUTE CLASSIC



The elegant style of this classic kitchen gives your home an authentic feel, teamed with delightful decorative motives and exclusive style.





PALETTE



OPERA WALNUT  
22 mm



OPERA WHITE  
22 mm



SOFT DOT GLASS  
4/22 mm

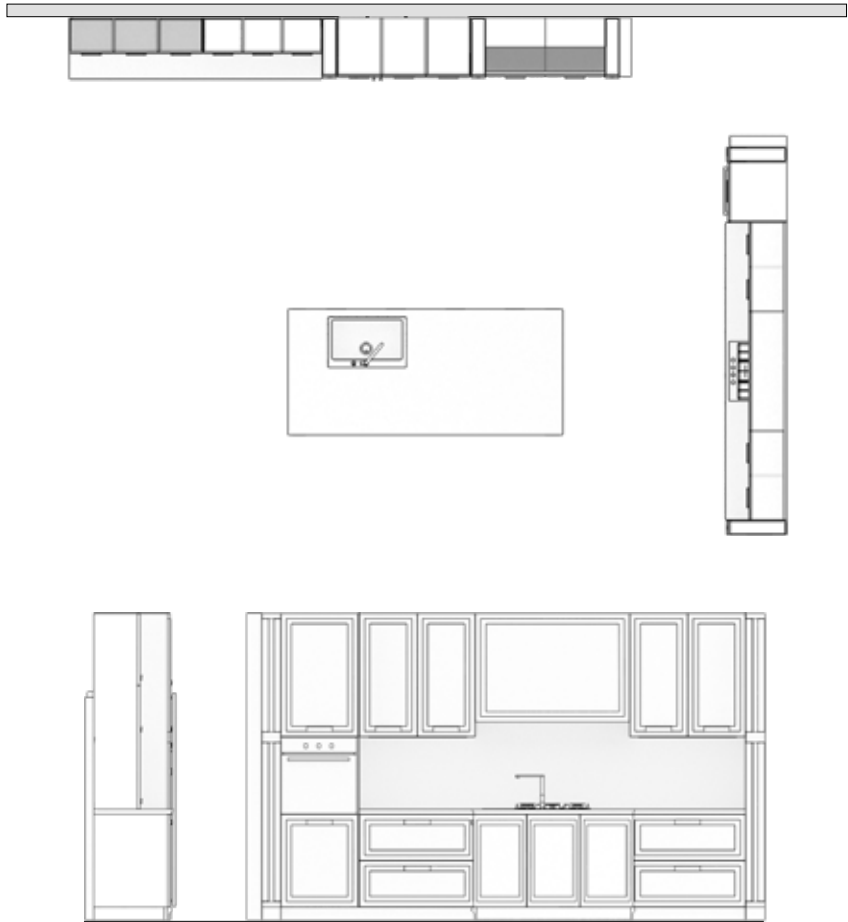

— **BASE WALL & TALL UNITS**  
carcass: off-white  
fronts: opera walnut & white finish  
worktop: aura  
pull handle  
soft dot glass

AVAILABLE IN

POLISH

GLASS



OPERA WHITE  
22 mm



OPERA WALNUT  
22 mm



SOFT DOT GLASS  
4/22 mm





# FREE

A MODEST STYLE, A BEAUTIFUL SENSATION



A Kitchen with simple, clean lines in which even the smallest details are designed to deliver everything you need from a kitchen and more.





PALETTE



WALNUT  
18 mm

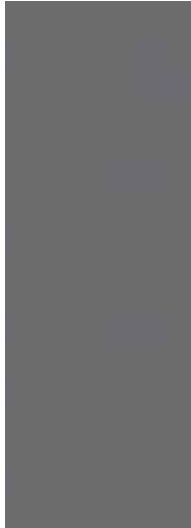

GREY MERCURY  
5/22 mm

— **BASE, WALL & TALL UNITS**  
carcass: grey  
fronts: walnut  
worktop: kelya  
pull handle  
grey mercury glass

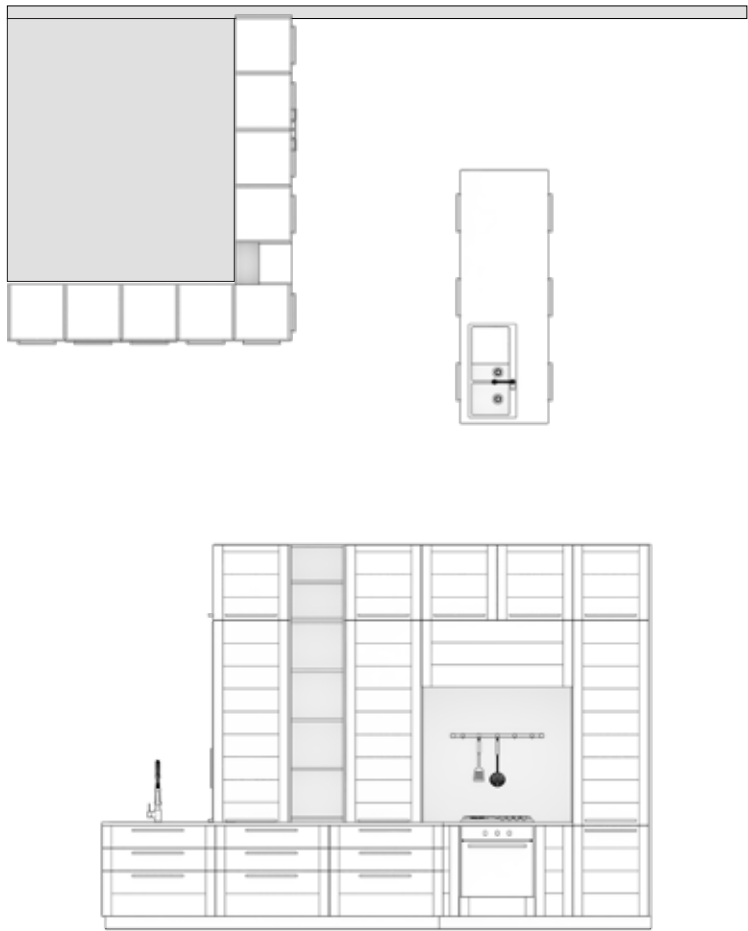

AVAILABLE IN

VENEER/WOOD		GLASS
TEAK 18 mm	WALNUT 18 mm	GREY MERCURY 5/22 mm



# ARROYO

TRANQUIL AND NATURAL DESIGN



The Arroyo Kitchen uses clean flowing lines, a fluted cabinet design and plush marble back splash to mimic the tranquility and beauty of nature.





# PALETTE



YELLOW CHESTNUT  
18 mm

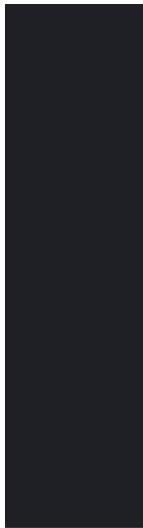

GRAPHITE  
18 mm



BROWN TINTED GLASS  
4/22 mm

— **BASE, WALL & TALL UNITS**  
carcass: grey  
fronts: yellow chestnut and graphite  
worktop: kelya  
glass: brown tinted

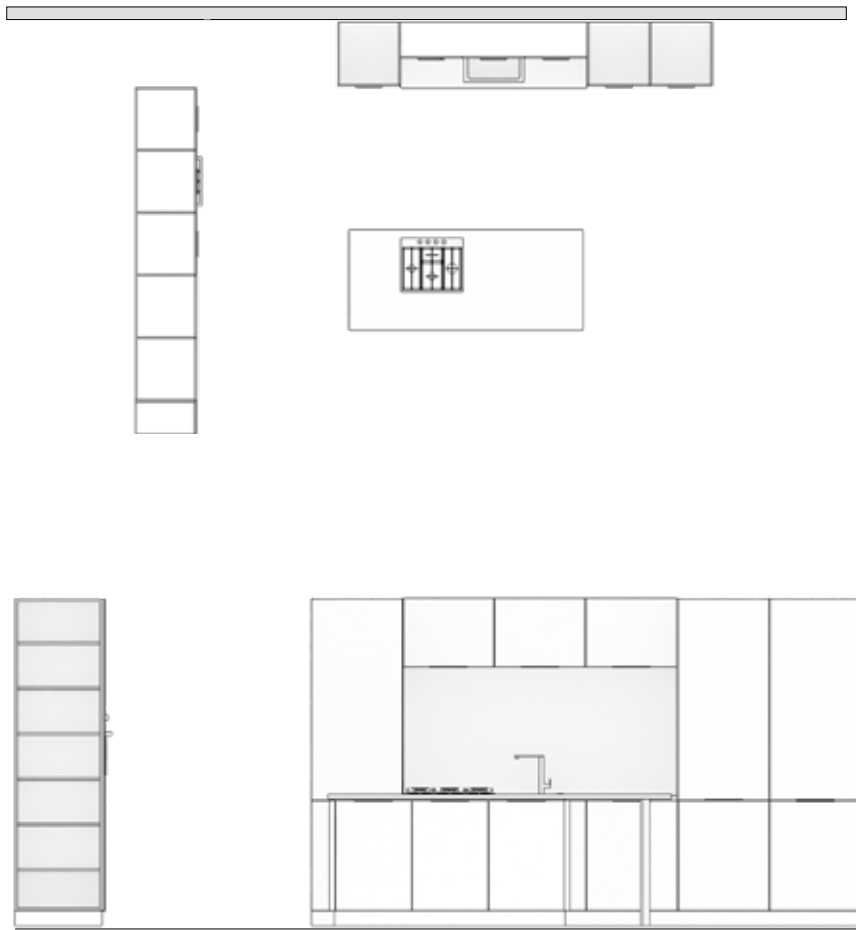

# AVAILABLE IN

## THERMOSET

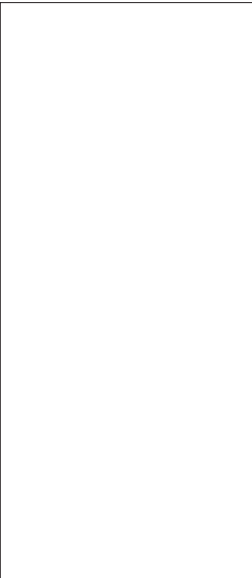

WHITE  
18 mm

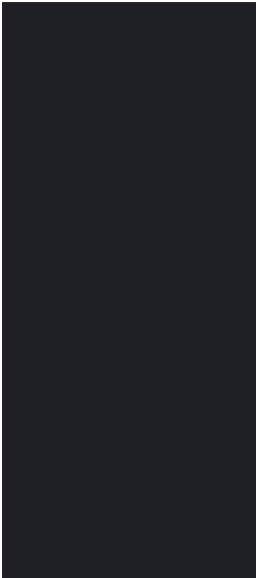

GRAPHITE  
18 mm



YELLOW CHESTNUT  
18 mm



BROWN TINTED GLASS  
4/22 mm

## GLASS





# IRIS

STRIKING MATERIALS AND BRIGHT COLORS





This combination of incredibly versatile colors and the material add a pop of vibrancy and character in the kitchen and creates a beautiful sensation.





PALETTE

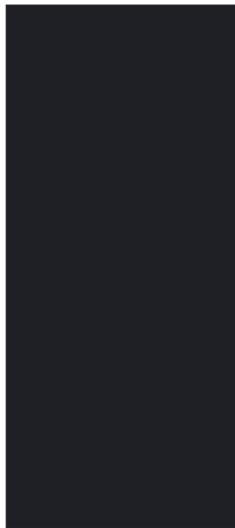

GRAPHITE  
18 mm



SOFT DOT GLASS  
4/22 mm



— **BASE WALL & TALL UNITS**  
carcass: grey  
fronts: graphite  
worktop: royal brown  
glass: soft dot

AVAILABLE IN

THERMOSET

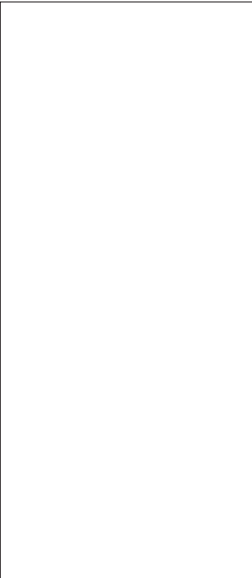

WHITE  
18 mm

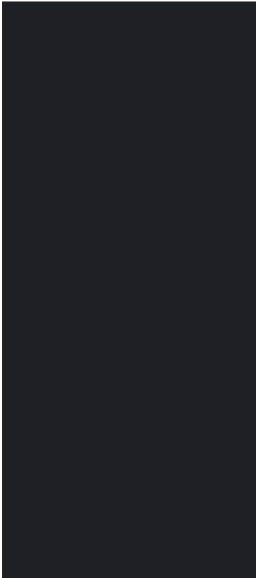

GRAPHITE  
18 mm



YELLOW CHESTNUT  
18 mm

GLASS



SOFT DOT GLASS  
4/18 mm





# IMPERIAL

THE WARMTH OF A TIMELESS DESIGN







There are designs that can never be forgotten. With Imperial kitchen, we want to remember the classics, because we love to innovate but without forgetting the designs which last a life time.







PALETTE

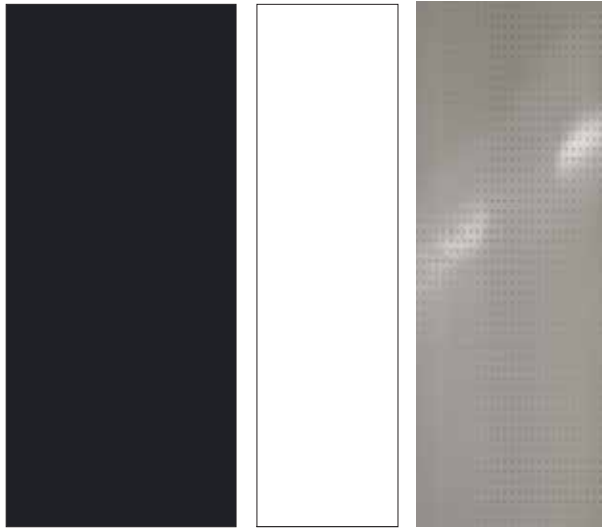

GRAPHITE  
25 mm

WHITE  
25 mm

SOFT DOT GLASS  
4/25 mm

— **BASE WALL & TALL UNITS**  
carcass: off-white  
fronts: white and graphite  
glass: soft dot  
pull handle



AVAILABLE IN

THERMOSET

GLASS



WHITE  
25 mm

GRAPHITE  
25 mm

YELLOW CHESTNUT  
25 mm

SOFT DOT GLASS  
4/25 mm





# DUSK

## INSPIRED BY AN URBAN MOOD

Dusk is a kitchen of tangible quality in terms of material and design solutions with an aesthetic that is defined with a balanced mix of the "rational" and the "natural".







# PALETTE



KENDAL OAK  
18 mm



GREY TINTED GLASS  
4/20 mm



WHITE  
17 mm

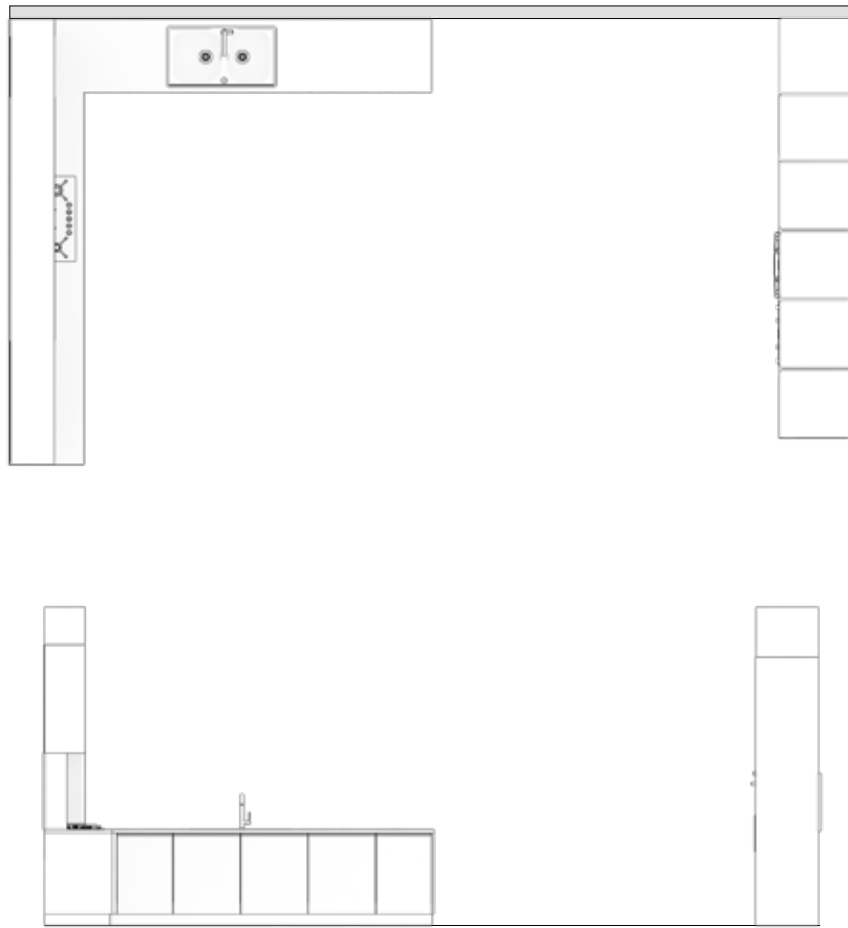

— **BASE, WALL & TALL UNITS**  
carcass: off-white  
fronts: kendal oak and white  
handle: less profile  
glass: grey tinted  
worktop: ivory mist

# AVAILABLE IN

## LAMINATES



GREY  
18 mm



ALANDPINE  
18 mm



KENDAL OAK  
18 mm



KANSAS OAK  
18 mm



TOBACCO OAK  
18 mm

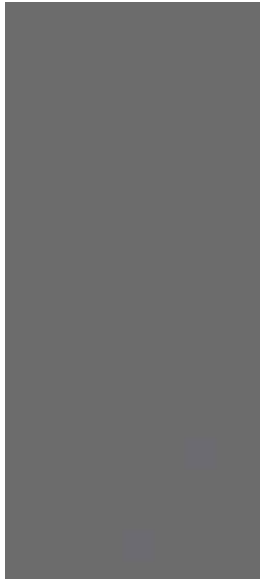

GREY TINTED GLASS  
4/20 mm

## GLASS





# MORENO

THE MARK OF A PRACTICAL KITCHEN





The Moreno kitchen combines practical design and economic solution. It delivers practicality and functionality to those seeking a kitchen that blends in with the style of a modern home.



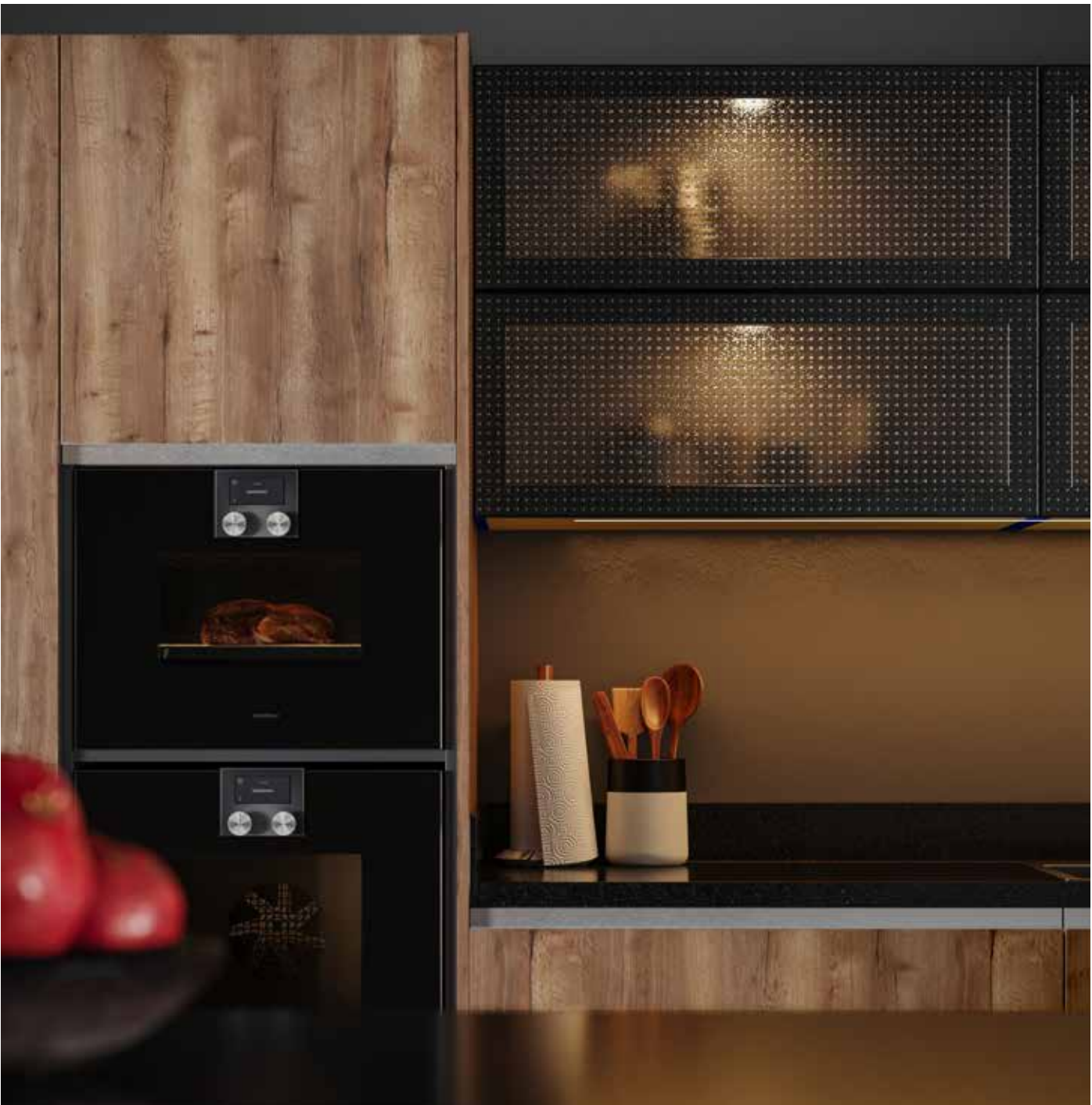

PALETTE

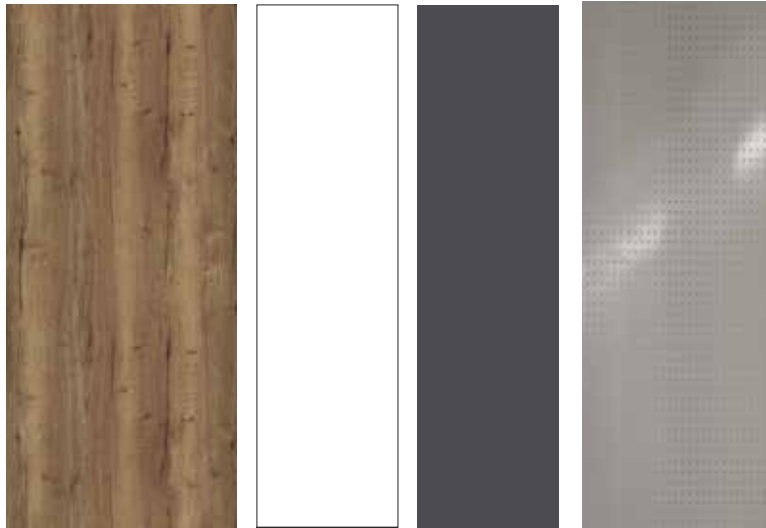

TOBACCO VALLEY OAK  
17 mm

WHITE  
17 mm

CHARCOAL GREY  
17 mm

SOFT DOT GLASS  
4/17 mm

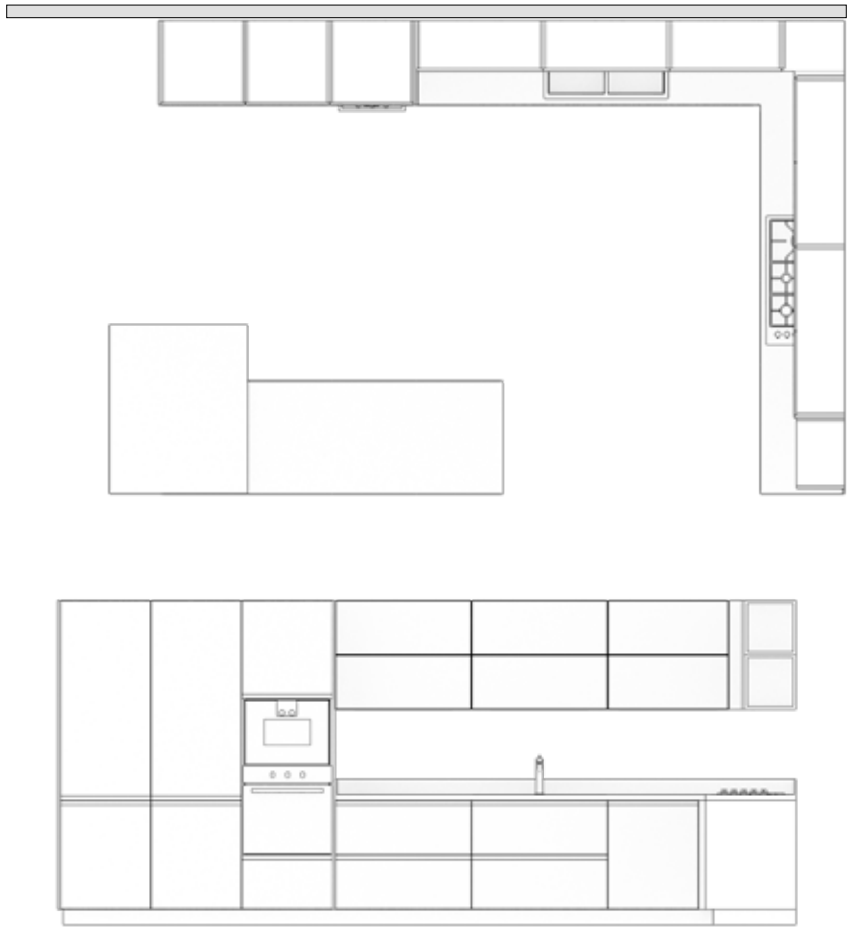

— **BASE, WALL & TALL UNITS**  
carcass: off-white  
fronts: tobacco valley oak  
handle less profile  
worktop: black quartz & dune prima

AVAILABLE IN

LAMINATES



WHITE  
17 mm

CHARCOAL GREY  
17 mm

CAPPADOCIA  
17 mm

KERALA CONCRETE  
17 mm

TOBACCO VALLEY OAK  
17 mm

WALNUT TEX  
17 mm

SOFT DOT GLASS  
4/20 mm

GLASS





# DUNE

PRACTICAL AND DISTINCTIVE





A kitchen with crisp and clean lines that sets easily in any household. It tucks in all your necessities and makes it simple to keep your kitchen tidy and organized.





PALETTE



BRUSHED OAK  
17 mm



WHITE  
17 mm



SOFT DOT GLASS  
4/17 mm

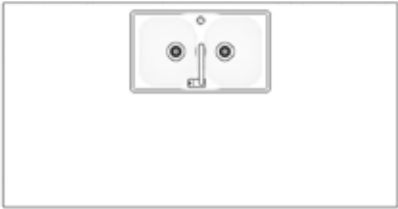

— **BASE, WALL & TALL UNITS**  
carcass: off-white  
fronts: brushed oak  
worktop: black quartz  
pull handle

AVAILABLE IN

LAMINATES



CANYON JURAPINE  
17 mm



NATURAL VENEER  
17 mm



TEAK  
17 mm



NOCE PERENNE  
17 mm



BRUSHED OAK  
17 mm

GLASS



SOFT DOT GLASS  
4/17 mm





# JUDE

THE BEAUTY OF SIMPLICITY



If you love originality and measured elegance, then minimal is the kitchen for you, designed to make your time in the kitchen a real pleasure.





# PALETTE



CANYON JURA PINE  
17 mm



WHITE  
17 mm

— **BASE, WALL & TALL UNITS**  
carcass: off-white  
fronts: canyon jura pine and white  
handle less profile  
worktop: ivory mist

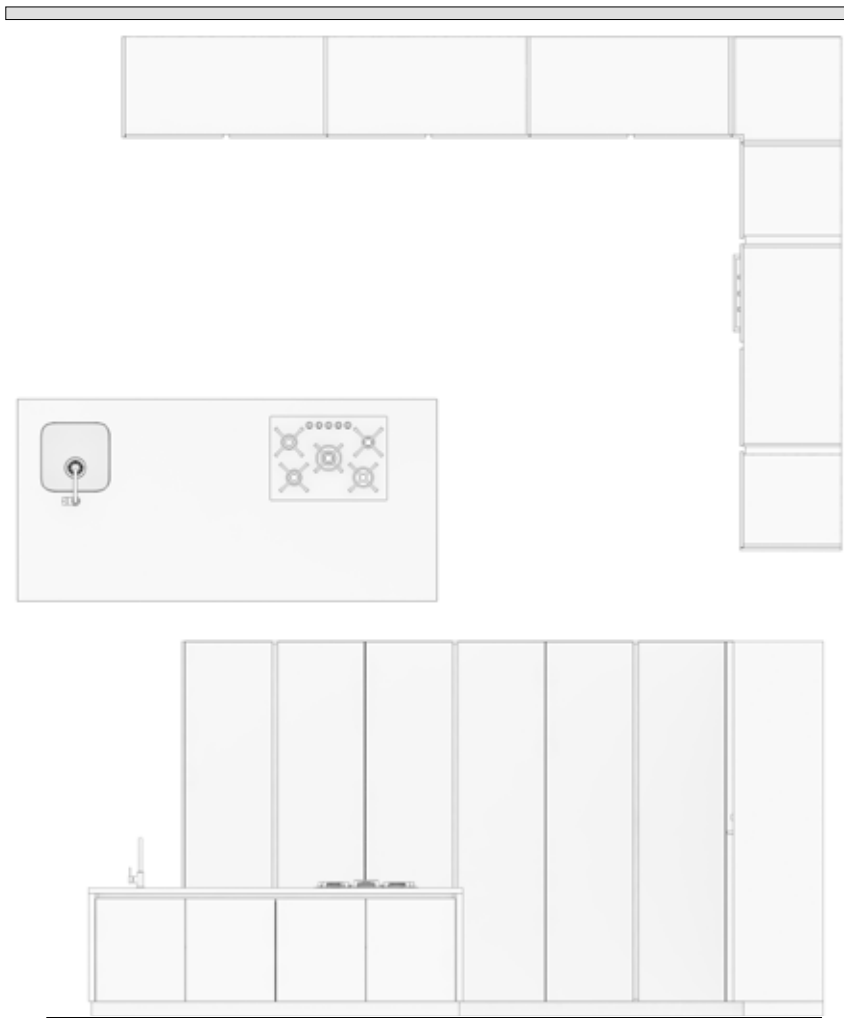

# AVAILABLE IN

## LAMINATES



WHITE  
17 mm



CAPPADOCIA  
17 mm



CANYON JURAPINE  
17 mm



NATURAL VENEER  
17 mm



TOBACCO VALLEY OAK  
17 mm



TEAK  
17 mm



KERALA CONCRETE  
17 mm

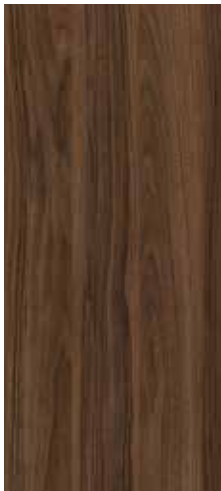

NOCE PERENNE  
17 mm



WALNUT TEX  
17 mm



BRUSHED OAK  
17 mm

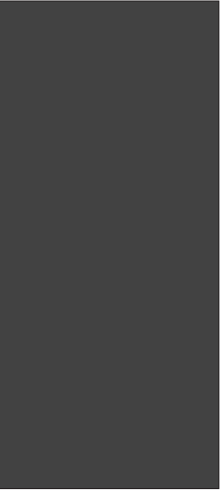

GREY  
17 mm



# ELLOT

AN OUTSTANDING BALANCE OF FINISHES







A kitchen with well-defined proportions, minimalist contours, and sophisticated range of finishes. Everything one needs in a perfect kitchen.





# PALETTE



BRUSHED OAK  
17 mm



GREY  
17 mm

— **BASE, WALL & TALL UNITS**  
carcass: grey  
fronts: brushed oak & grey  
handle less profile  
worktop: carbon aggregate

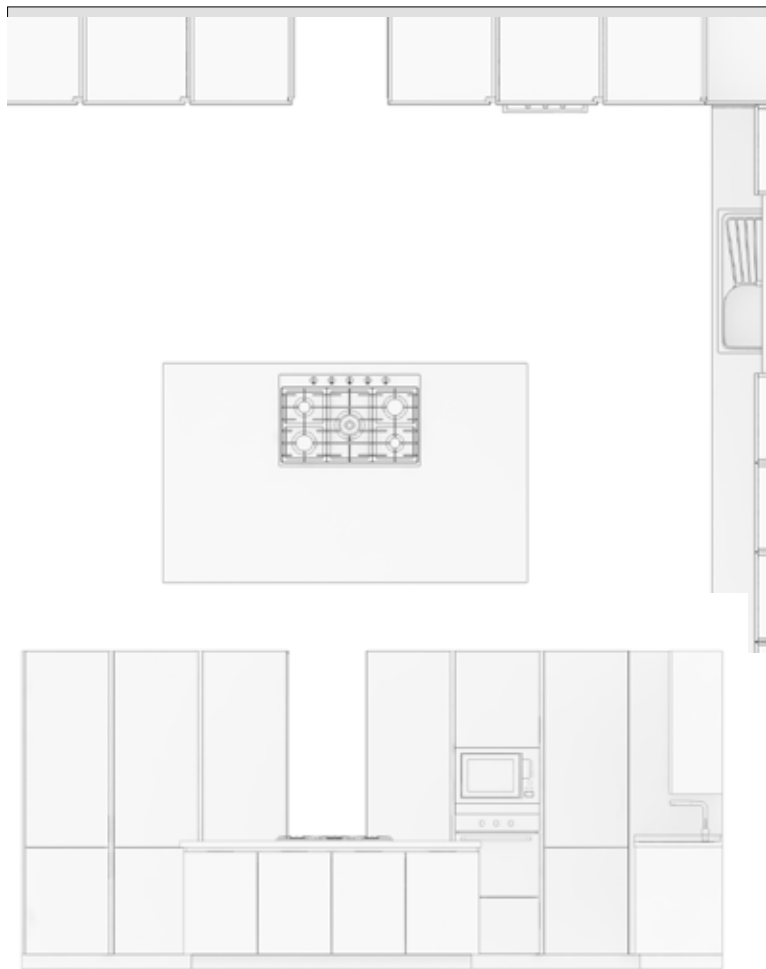

# AVAILABLE IN

## LAMINATES

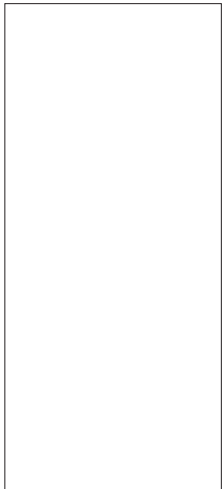

WHITE  
17 mm



CAPPADOCIA  
17 mm



CANYON JURAPINE  
17 mm



NATURAL VENEER  
17 mm



TOBACCO VALLEY OAK  
17 mm



TEAK  
17 mm



KERALA CONCRETE  
17 mm

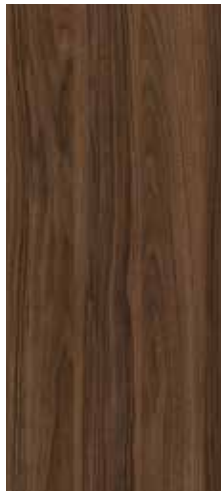

NOCE PERENNE  
17 mm



WALNUT TEX  
17 mm



BRUSHED OAK  
17 mm

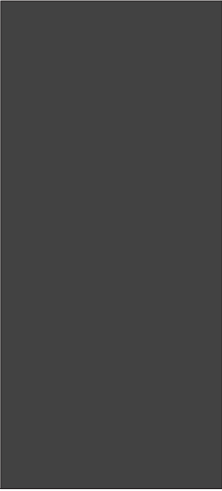

GREY  
17 mm

# KITCHEN ACCESSORIES

## The Kitchen Storage Wonder!

What is the best way to organise my base units? How many cutlery trays do I need? Which waste separation system should I choose? What is more practical here: a larder unit or a pantry unit with internal pull-outs?

The following pages will give you some helpful suggestions on how to better organize your kitchen.



BASE PLATE RACK  
FG0100-15271 | 15272  
564W x 500D x 110H



WALL PLATE RACK  
FG0100-15274 | 15275  
843W x 245D x 520H



DETERGENT BASKET (Soft Closing)  
FG010015260  
235W x 445D x 440H

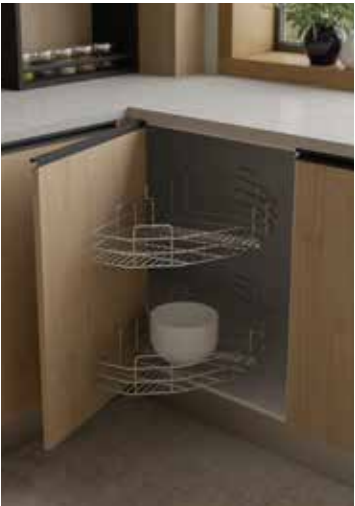

HALF MOON BASKET  
FG010008379  
760W x 390D x 100H



CUTLERY TRAY  
FG01000-8397 | 8395 | 8398  
500 | 600 | 900W x 490D x 45H



WASTE BIN  
FG010008382  
277W x 277D x 355H



PULL-OUT SHELVES  
FG010015270 | FG010015269  
860W x 450D x 470H



BASKET FOR SPICE JARS  
FG010015267  
110W x 500D x 520H



UNDER SINK TRAY  
FG010015265  
860W x 505D x 230H



DUST BIN  
FG010015266  
860W x 505D x 230H



JOLLY BASKET  
FG010027731  
110W x 470D x 485H



BASE PLATE RACK  
FG010027733  
564W x 425D x 140H



DISH RACK  
FG010027732  
865W x 280D x 65H





#### Tandem Box Drawer Height M

- FG010027319 | FG010027434 (Blumotion)  
FG010027320 | FG010027435 (Tip-on Blumotion)
- Width 600 - 1200 mm
  - Depth 500 mm
  - Height 98.5 mm
  - Dynamic Carrying capacity 30 Kg
  - Includes integrated BLUMOTION for silent and effortless closing action, can be combined with SERVO-DRIVE
  - Either with TIP-ON BLUMOTION for handle-less furniture, or even for furniture with handle elements as a design feature



#### Tandem Box Inner Pull-out Box Cover

- FG010027324 | FG010027438 (Blumotion)
- Width 600 - 1200 mm
  - Depth 500 mm
  - Height 224 mm
  - Dynamic Carrying capacity 30 Kg
  - Easy access from three sides
  - Individually opening pull-outs allow for a complete overview and convenient removal from above
  - Light operating forces even with heavily-laden pull-outs
  - Flexible cabinet dimensions possible



#### Space Corner Tandem Height D

- FG010027330 (Blumotion)
- Depth 600 mm
  - Height 227 mm
  - Special drawer side which allows you to create personalised designs
  - Timelessly simple with BOXCAP or with a design element of your choice
  - Closed and seamless side panels
  - Consistent colour scheme



#### Aventos HK-XS Tip-on Lift System

- FG010027365
- Well-suited for low frontal heights in the wall cabinet, the high cabinet and over the refrigerator
  - Cabinet height KH 240-600 mm
  - Internal cabinet depth LT min. 125 mm (100 mm)
  - Closes silently and effortlessly in conjunction with CLIP top BLUMOTION hinges
  - TIP-ON for handle-less stay lifts
  - Light operating forces
  - Perfect motion with a variable stop
  - Simple, infinitely variable lift mechanism



#### Tandem Box Pull-out BOXCAP

- FG010027322 | FG010027437 (Blumotion)  
FG010027323 | FG010027439 (Tip-on Blumotion)
- Width 600 - 1200 mm
  - Depth 500 mm
  - Height 224 mm
  - Dynamic Carrying capacity 30 Kg
  - Includes integrated BLUMOTION for silent and effortless closing action, can be combined with SERVO-DRIVE
  - Either with TIP-ON BLUMOTION for handle-less furniture, or even for furniture with handle elements as a design feature



#### Sink Cabinet Pull-out BOXCAP

- FG010027325 (Blumotion)  
FG010027552 (Tip-on Blumotion)
- Width 800 - 1200 mm
  - Depth 500 mm
  - Height 98.5 mm
  - Dynamic Carrying capacity 30 Kg
  - Includes integrated BLUMOTION for silent and effortless closing action
  - Either with TIP-ON BLUMOTION for handle-less furniture, or even for furniture with handle elements as a design feature



#### Servo Drive for Tandem Box

- FG0100-27326 | 27327 | 27328
- With SERVO-DRIVE, opening handle-less pull-outs is child's play.
  - A light touch on the front with the foot, knee or hip is all that's required.



#### Tandem Box Inner Drawer Height M

- FG010027321 | FG010027436
- Width 600 - 1200 mm
  - Depth 500 mm
  - Height 98.5 mm
  - Dynamic Carrying capacity 30 Kg
  - Easy access from three sides
  - Individually opening pull-outs allow for a complete overview and convenient removal from above
  - Light operating forces even with heavily-laden pull-outs
  - Flexible cabinet dimensions possible



#### Space Corner Tandem Height M

- FG010027331 (Blumotion)
- Depth 600 mm
  - Height 101 mm
  - Special drawer side which allows you to create personalised designs
  - Timelessly simple with BOXCAP or with a design element of your choice
  - Closed and seamless side panels
  - Consistent colour scheme



#### Aventos HF Servo Drive

- FG010027329
- Ideal for wall cabinets with divided fronts
  - Cabinet height KH 480-1040 mm
  - Cabinet width KB up to 1800 mm
  - Silent and effortless closing, thanks to BLUMOTION
  - Light operating forces
  - Simple, infinitely variable lift mechanism
  - Centre hinge with finger safety feature

# KITCHEN APPLIANCES

We want to be a part of your Kitchen!

## HOODS

An exclusive range of Hoods for a smoke-free kitchen.



FG010009934  
Built in Hood (80cm)

Material: SS430 + Silver  
Suction: 300-800 m³/h  
Switches: 4 speed Level  
Features:  
Aluminum grease filter  
Lamps: 2x20 W Halogen Lights  
Carbon Filter for Recirculation  
Air Outlet: 150mm  
Noise level: 43-64 dba  
Origin: Made in Italy



FG010027868  
Built in Hood (90cm)

Material: SS430 + Black Panel  
Suction: 1300 m³/h  
Switches: Touch Control - 3 Speed Level  
Features:  
Wing-like surround suction plate  
100-sec turbo system  
Illuminated side touch control  
Rounded edge  
Oil filter: Corrugated filter  
Noise level ≤57dB  
Origin: Made in China



NEW

FG010028170  
Wall Mounted Hood (60cm)

Material: Stainless Steel  
Suction: 650 m³/h  
Switches: Mechanical Push Button control | 3 speed levels  
Dishwasher Safe Aluminium Cassette Filter  
2 x 4W LED Light Type  
Origin: Made in China



FG010028166  
Wall Mounted Hood (90 cm)

Material: Stainless Steel  
Suction: 650 m³/h  
Switches: Mechanical Push Button control | 3 speed levels  
Dishwasher Safe Aluminium Cassette Filter  
2 x 4W LED Light Type  
Origin: Made in China



FG010027872  
Wall Mounted Hood (90 cm)

Material: SS430  
Suction: 750 m³/h  
Features:  
Canopy Design  
Black Steel Body  
Buffle filters  
Touch Button operation  
Double neck  
Complete copper winding around the motor  
Origin: Made in China



FG010027873  
Wall Mounted Hood (90cm)

Material: Glass  
Suction: 750 m³/h  
Features:  
Canopy Design  
Black Steel Body  
Buffle filters  
Touch Button operation  
Double neck  
Complete copper winding around the motor  
Origin: Made in China



NEW

FG010028176  
Wall Mounted Hood (90 cm)

Material: SS430  
Suction: 850 m³/h  
Switches: Manual Control  
Complete copper winding around the motor  
Origin: Made in China



## HOBS

Our extremely sophisticated range of Hobs harmonized with an array of cutting-edge and “easy to use” functions will make your cooking experience an exciting one.



FG010027286

Material: SS304  
Size: 60cm  
Energy type: NG/LPG  
Flame pressure + Position:  
Center Left Outside: Double Ring (4.0 KW)  
Front Right: Semirapid light flame (1.40 KW)  
Rear Right: Rapid (2.80 KW)  
Features:  
Customizable panel control | Automatic ignition  
Premium cast iron grids | Auto Lock System  
Cast iron wok support | Cable with plug  
Origin: Made in Italy



FG010027285

Material: SS304  
Size: 60cm  
Energy type: NG/LPG  
Flame pressure + Position:  
Front Left: Double ring (4.0 KW)  
Rear Left: Semi-rapid (1.75 KW)  
Front Right: Double ring (1.0 KW)  
Rear Right: Semi-rapid (2.80 KW)  
Features:  
Customizable panel control | Automatic ignition  
Premium cast iron grids | Auto Lock System  
Cast iron wok support | Cable with plug  
Origin: Made in Italy



FG010027294

Material: Tempered glass  
Size: 90cm  
Energy type: NG/LPG  
Flame pressure + Position:  
Right: Double ring (4.85 KW)  
Left: Double ring (4.85 KW)  
Center: Semi rapid (1.75 KW)  
Features:  
Even flame technology | Heat efficiency > 60%  
Safety ignition pin | Flame failure device (FFD)  
Cast iron grate | Fast ignition | Low battery reminder  
Removeable washing cup  
Origin: Made in China

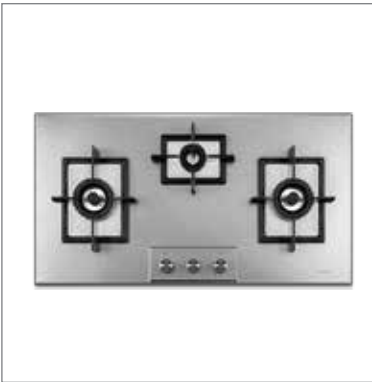

FG010027293

Material: SS304  
Size: 90cm  
Energy type: NG/LPG  
Flame pressure + Position:  
Right: Double ring (4.85 KW)  
Left: Double ring (4.85 KW)  
Center: Semi rapid (1.75 KW)  
Features:  
EPS technology | Heat efficiency > 60%  
Safety ignition pin | Flame failure device (FFD)  
Cast iron grate | Fast ignition | Low battery reminder  
Removeable washing cup  
Origin: Made in China



FG010027287

Material: SS304  
Size: 90cm  
Energy type: NG/LPG  
Flame pressure + Position:  
Front Left: Rapid (3.0 KW)  
Rear Left: Semi-rapid (1.75 KW)  
Front Right: Semi-rapid (1.0 KW)  
Rear Right: Auxiliary (1.0 KW)  
Central: Double ring (4 KW/5 KW)  
Features:  
Flame failure device (FFD) | Auto ignition integrated  
Cast iron grids pan support | Removable washing cups  
Origin: Made in Italy



FG010027869

Material: Glass  
Size: 78cm  
Energy type: NG/LPG  
Flame pressure + Position:  
Right: Double ring (4.5 KW)  
Left: Double ring (4.5 KW)  
Center: Semi rapid (2.3 KW)  
Features:  
Cast iron pan supports | EPS Burners  
Auto Ignition | Flame failure device (FFD)  
Weight 65 kg | 780 L X 450 W X 0.75 H mm  
Origin: Made in China



FG010027870

Material: Steel  
Size: 78cm  
Energy type: NG/LPG  
Flame pressure + Position:  
Right: Double ring (4.5 KW)  
Left: Double ring (4.5 KW)  
Center: Semi rapid (2.3 KW)  
Features:  
Cast iron pan supports | EPS Burners  
Auto Ignition | Flame failure device (FFD)  
Weight 65 kg | 780 L X 450 W X 0.75 H mm  
Origin: Made in China



FG010027871

Material: Glass  
Size: 90cm  
Energy type: NG/LPG  
Flame pressure + Position:  
Right: Double ring (4.5 KW)  
Left: Double ring (4.5 KW)  
Center: Semi rapid (1.75 KW)  
Features:  
Easy clean scratch resistant surface | Auto Ignition: Yes  
Even heat distribution | FFD Safety: Yes  
Italian Burners (SABAF) | Spacious Design for Big Pots  
Origin: Made in China



FG010028165

Material: 8mm Tempered Glass  
Size: 78cm  
Energy type: NG/LPG  
4 Gas Burner with FFD + One Hotplate  
Cast Iron | Front Panel Control  
UK Type Plug  
Cartoon Box Packing  
Origin: Made in China



FG010028173

Material: Stainless Steel  
Size: 78cm  
4 Gas Burner with FFD | 2 Vetro Ceramic Area  
Energy type: NG/LPG  
Flame pressure + Position:  
Front Left: Rapid (3.6 KW)  
Rear Left: Semi Rapid (1.78 KW)  
Center: (1-1.8 KW)  
Rear Right: (1.78 KW)  
Front Right: (3.6 KW)  
Features:  
Cast iron pan supports | UK Type Plug  
Cartoon Box Packing  
Origin: Made in China



FG010028171

Material: 201 Stainless Steel  
3 Chinese Burner with FFD Cast Iron  
Battery Ignition | Bakelite Knob  
Flame Power: 4.5KW x 2 + 1.7KW x 1  
Origin: Made in China

FG010028172

Material: 8mm Tempered Glass  
3 Chinese Burner | Enamel Grill with FFD  
Battery Ignition | Bakelite Knob  
Flame Power: 4.5KW x 2 + 1.7KW x 1  
Origin: Made in China

## OVENS & MICROWAVES

Designed to cater to individual needs of every kitchen, Interwood now brings to you an exciting selection of ovens that offer precision and performance like never before. With a variety of innovative features now you can cook up a delicious cuisine in no time.



FG010027305

Material: SS304  
Size: 60cm  
Cavity: 25 Litre  
Energy Type: Electric  
Handle: Aluminium  
Power: 800 W output, 850 W grill, 1350 W microwave  
Features:  
Large LED display | Child safety lock  
Constant temperature control technology  
8 express cooking menus | Microwave & grill heating  
Independent ventilation system  
Pop-out rotatory control  
Origin: Made in China



NEW

FG010028174

Material: Metal Black  
Size: 60cm  
Cavity: 30 Litre  
Energy Type: Electric  
Features:  
Inox Front | Push Button Door  
Electroplated Buttons & Knobs  
Green & Yellow LED  
Black Control Color Panel  
Origin: Made in China



FG010027877

Material: Steel, Black Finish  
Size: 60cm  
Cavity: 56 Litre  
Energy Type: Electric  
Features:  
04 functions Convection fan | Aluminium bar handle  
Automatic cut off time  
Cavity cooling system | Oven ventilation system  
Double glazed glass door | Large viewing window  
5 shelf positions | Power: 2700w  
Origin: Made in China



FG010027306

Material: Black tempered glass  
Size: 60cm  
Cavity: 25 Litre  
Energy Type: Electric  
Handle: Aluminium  
Power: 800 W output, 850 W grill, 1350 W microwave  
Features:  
Large LED display | Child safety lock  
Constant temperature control technology  
8 express cooking menus | Microwave & grill heating  
Independent ventilation system | Touch control  
Pop-out rotatory control  
Origin: Made in China



FG010027874

Material: SS304 + Glass  
Size: 60cm  
Cavity: 25 Litre  
Features:  
Built-in-microwave oven | LED display  
5 micro power levels | Child lock  
8 built-in auto cook options  
Mirror glass door | Stainless steel cavity  
Origin: Made in China



FG010027876

Material: Glass, Black Finish  
Size: 60cm  
Cavity: 56 Litre  
Energy Type: Electric  
Features:  
04 functions Convection fan | Aluminium bar handle  
Automatic cut off time  
Cavity cooling system | Oven ventilation system  
Double glazed glass door | Large viewing window  
5 shelf positions | Power: 2700w  
Origin: Made in China



FG010027649

Material: Tempered Glass  
Size: 60cm  
Cavity: 70 Litre  
Energy Type: Electric  
Features:  
Classic Design | A Energy Class  
3D Convection Fan  
Origin: Made in China



FG010027875

Material: SS Finish  
Size: 60cm  
Cavity: 25 Litre  
Features:  
Built-in-microwave oven | LED display  
5 micro power levels | Child lock  
8 built-in auto cook options  
Mirror glass door | Stainless steel cavity  
Origin: Made in China



NEW

FG010028168

Material: Black Glass  
Size: 60cm  
Cavity: 34 Litre  
Energy Type: Electric  
Features:  
Grill & Microwave Type | Push Open Door  
Stainless Steel Cavity | Glass Control Panel  
Auto Reheat | Defrosting | Child Safety Lock  
Origin: Made in China



NEW

FG010028167

Material: Glass Black Panel  
Size: 60cm  
Cavity: 62 Litre  
Energy Type: Electric  
Features:  
8 Function (0 + 7) Low and High Grill + Fan  
Resistance with Toven Lamp  
Digital Timmer | Pop-up Knobs | Side Wire Rack  
UK Type Plug | Strafouam Packing  
1 Oven Tray + 1 Oven Grid  
Origin: Made in China



NEW

FG010028175

Material: Stainless Steel Panel  
Size: 60cm  
Cavity: 62 Litre  
Energy Type: Electric  
Features:  
6 Function (0 + 5) Bottom and Upper  
Resistance with Toven Lamp  
Mechanical Tower | Pop-up Knobs  
Side Wire Rack | Inox Strip in door  
UK Type Plug | Strafouam Packing  
1 Oven Tray + 1 Oven Grid  
Origin: Made in China



## SINKS & TAPS

Introducing a sophisticated and elegant range of Sinks and Taps, which have the technology of preventing water wastage, setting your Interwood kitchen apart from the rest.



FG010004370  
SINGLE BOWL

Material: Stainless Steel 304  
Size: 510 W x 510 D x 175 H  
Installation: Over the counter  
Including: Drainage kit  
Finish: Bright  
Origin: Made in Portugal



NEW

FG010028239  
SINGLE BOWL SINK

Material: Stainless Steel 304  
Size: 584 W x 457 W x 228 H  
Installation: Under the counter  
Including: Drainage kit + Chopping Board  
Finish: Satin  
Origin: Made in China



FG010004372  
SINGLE BOWL WITH TRAY

Material: Stainless Steel 304  
Size: 860 W x 500 D x 200 H  
Installation: Over the counter  
Including: Drainage kit  
Finish: Bright  
Origin: Made in China



FG010004383  
SINGLE BOWL

Material: Stainless Steel 304  
Size: 436 W x 436 D x 200 H  
Installation: Over/Under the counter  
Including: Drainage kit  
Finish: Satin  
Origin: Made in Portugal



FG010004371  
SINGLE BOWL

Material: Stainless Steel 304  
Size: 440 W x 440 D x 200 H  
Installation: Over/Under the counter  
Including: Drainage kit  
Finish: Bright  
Origin: Made in Portugal



FG010004375  
SINK OKIO FLAT

Material: Stainless Steel 304  
Size: 1160 W x 50 D x 160/200 H  
Installation: Over the counter  
Finish: Bright  
Origin: Made in China



FG010004373  
2 BOWLS WITH TRAY

Material: Stainless Steel 304  
Size: 1160 W x 500 D x 160 / 200 H  
Installation: Over the counter  
Including: Drainage kit  
Finish: Bright  
Origin: Made in Portugal



FG010004384  
SINGLE BOWL

Material: Stainless Steel 304  
Size: 776 W x 436 W x 200 H  
Installation: Over/Under the counter  
Including: Drainage kit  
Finish: Satin  
Origin: Made in Portugal

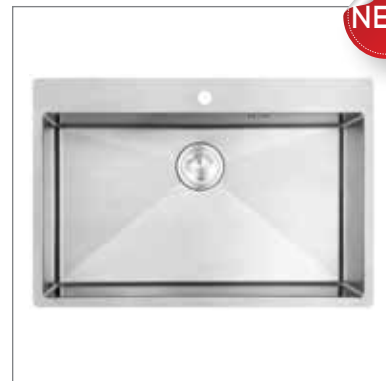

NEW

FG010028240  
SINGLE BOWL SINK

Material: Stainless Steel  
Size: 810 W x 510 D x 254 H  
Chopping Board | Drain Pipe  
Stainer Basket  
Installation: Over the counter  
Finish: Bright  
Origin: Made in China



FG010004376  
1-1/2 BOWL WITH TRAY

Material: Stainless Steel 304  
Size: 1000 W x 500 D x 170 H  
Installation: Over the counter  
Including: Drainage kit  
Finish: Bright  
Origin: Made in Portugal



NEW

FG010028241  
1-1/2 BOWL SINK

Material: Stainless Steel  
Size: 813 W x 483 D x 254 H  
Installation: Under the counter  
Including: Drainage kit | Rollmat | Stainer Basket  
Finish: Bright  
Origin: Made in China



FG010004385  
1-1/2 BOWL WITH TRAY

Material: Stainless Steel 304  
Size: 510 W x 510 D x 175 H  
Installation: Over the counter  
Including: Drainage kit  
Finish: Bright  
Origin: Made in Portugal



NEW

FG010028242

Size: 205 W x 378 H mm  
Finish: Chrome  
Origin: Made in Portugal



NEW

FG010028243

Size: 190 W x 337 H mm  
Finish: Chrome  
Origin: Made in Portugal

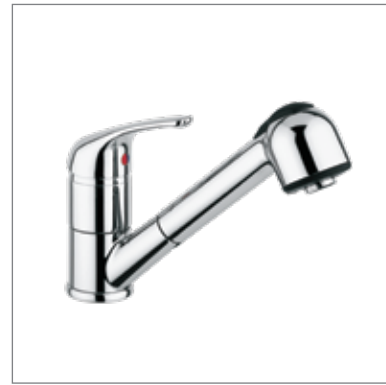

FG010004382

Material: Brass  
Size: 145/130 H mm  
Installation: Over the counter with hose  
Finish: Chrome  
Origin: Made in Portugal



NEW

FG010028180

Built-in One Door Larder  
Integrated Handle | White Color  
Net Capacity 316 ltr | 5 Interior Lights  
Cable with Plug 180cm | Egg Tray



NEW

FG010028181

Built-in One Door Freezer  
Integrated Handle | White Color  
Net Capacity 204 ltr | Ice Cubes Tray  
Cable with Plug 180cm

## WORK TOPS

### DEKTON



FG010027757  
AURA



FG010027756  
KELYA



FG010027759  
MARENGO



FG010028119  
NAVONA WHITE



FG010028116  
ARCAN GREY



FG010028121  
GREY EMPRADOR

### MARBLE



FG010028114  
CHINA VERONA



FG010028117  
MOON LIGHT GREY



FG010028115  
ROYAL BROWN



FG010028120  
ARMANI GREY



FG010028118  
AUTUMN GREY



FG010028122  
BLACK

### GRANITE



MONTELLI



FG010008697  
BLIZZARD

CORIAN



FG010008695  
IVORY MIST



FG010027683  
WHITE ONYX



FG010028126  
ARTISTA CANVAS



FG010027682  
DUNE PRIMA



FG010008689  
AURORA

POLYESTER



FG010027764  
SNOW WHITE



FG010027762  
AURORA

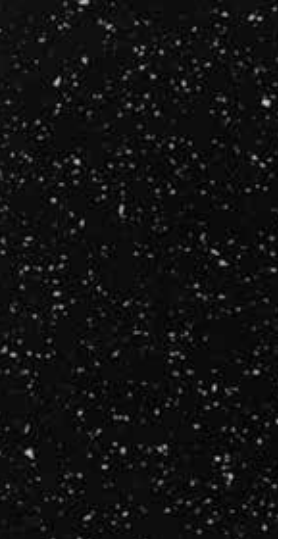

FG010027763  
STAR NIGHT



FG010012849  
BLACK



FG010028125  
ARTISTA DUST



FG010027680  
CARBON AGGREGATE



FG010008694  
BLACK QUARTZ

HANDLES



| GS-01-1087  
ANTIQUE BRASS



| GS-01-1086  
ANTIQUE BRASS



| GS-01-1079  
ANTIQUE BRASS



| GS-01-1077  
VINTAGE BLACK



| GS-23-1085  
GOLDEN



| GS-23-1085OBN  
OXIDIZED BRUSHED NICKLE



| GS-23-1101  
VINTAGE PEWTER



| GS-23-1087OBN  
OXIDIZED BRUSHED NICKLE



| GS-23-1087  
BLACK



| GS-23-1086  
BLACK



| GS-23-1086OBN  
OXIDIZED BRUSHED NICKLE

LED LIGHTS



| KCL-LEDAM6  
OVER-CABINET LIGHT



| KCL-LEDM6IR  
BAR LIGHT WITH SENSOR  
FOR CABINET/WARDROBE  
INTERIOR



| KCL-LBL2M3045  
UNDER-CABINET BAR LIGHT



| KCL-LDL2M30501R  
DRAWER LIGHT WITH SENSOR



| KCL-LED4SQ14K  
PLINTH LIGHT

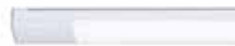

| FG0100-15257 | 15258  
INSIDE BASE CABINET/DRAWER



| KCL-LEDA100TS  
LED STRIP LIGHT LENGTH 1025mm  
ONLY FOR 38mm TOP



| FG0100-15255 | 15256  
UNDER-CABINET LIGHT  
WITH SWITCH



| FG0100-13289 | 13290  
OPEN UNITS/INSIDE GLASS CABINETS/  
COUNTER



| FG0100-15253 | 15254  
UNDER-CABINET LIGHT  
WITHOUT SWITCH



| DRIVER  
KCL-AED151LSVKL6P  
FOR LIGHTS:  
LEDAM6, LEDM6-IR, LBL2M3-045,  
LDL2M3-050IR & LED-C045



| DRIVER  
KCL-AED151LSVKL3P  
FOR LIGHTS:  
LEDA100TS, GAL-21S & GDL-L21R



| DRIVER  
FG010013291  
24V, 50W  
WITH CABLE AND EU PLUG



| SAMPLE BOX  
FG010013292  
24V, 6-WAYS+MML



CABINETRY

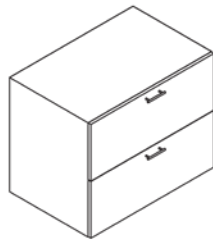

DOUBLE EQUAL DRAWER BASE CABINET  
CODE SIZE mm (W)  
BS\_2EQ-FO\_7S 300, 400, 450, 500, 600  
800, 900, 1000, 1200

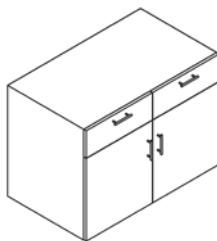

DOUBLE DRAWER & SHUTTER BASE CABINET  
CODE SIZE mm (W)  
BS2\_A-FO\_7S 800, 900, 1000, 1200

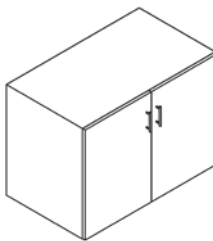

DOUBLE SHUTTER BASE CABINET  
CODE SIZE mm (W)  
BS2-FO\_7S 800, 900, 1000, 1200

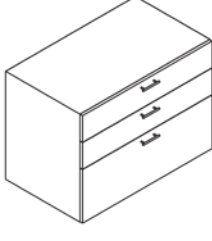

TRIPPLE DRAWER BASE CABINET FOR HOB  
CODE SIZE mm (W)  
BS\_D3\_2EQ\_TB-FO\_7S 450, 500, 600, 800  
900, 1000, 1200



FOUR DRAWER BASE CABINET  
CODE SIZE mm (W)  
BS\_D4E-FO\_7S 400, 500, 600  
800, 900, 1000

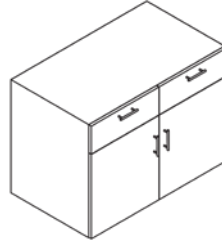

DOUBLE SHUTTER & DRAWER SINK BASE CABINET  
CODE SIZE mm (W)  
BS2\_A-FO\_7S 800, 900, 1000, 1200

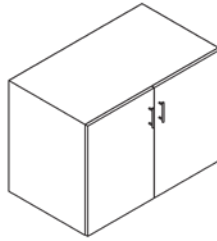

DOUBLE SHUTTER SINK BASE CABINET  
CODE SIZE mm (W)  
BS2-FO\_7S 800, 900, 1000, 1200

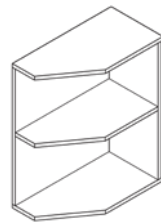

OPEN END BASE CABINET  
CODE SIZE mm (W)  
BOP\_CB-FO\_7S 300



OPEN BASE CABINET  
CODE SIZE mm (W)  
300-BOP\_CB-17-WA 300



OPERA OPEN END BASE CABINET  
CODE SIZE mm (W)  
337-WOP\_CB\_N-203-WA 600

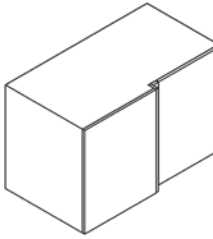

CORNER BASE CABINET LEFT  
CODE SIZE mm (W)  
1135-BC1\_SL\_A053-FO\_7S 1135

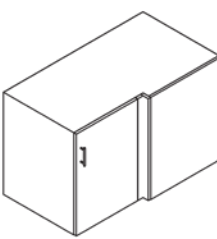

CORNER BASE CABINET RIGHT  
CODE SIZE mm (W)  
1135-BC1\_SR\_A053-FO\_7S 1135

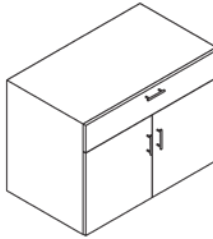

SINGLE DRAWER DOUBLE SHUTTER BASE CABINET  
CODE SIZE mm (W)  
BS2\_1D-FO\_7S 800, 900, 1000, 1200

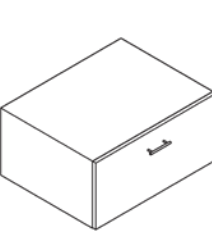

SINGLE DEEP DRAWER BASE CABINET  
CODE SIZE mm (W)  
BS\_1TB-FO\_7S 600, 800, 900, 1000, 1200

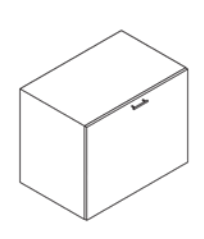

BASE CABINET DISHWASHER  
CODE SIZE mm (W)  
600-BS1\_WOP-FO\_7S 600

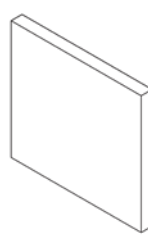

PILLAR BASE CABINET  
CODE SIZE mm (W)  
75-BS\_PILLAR-14 75

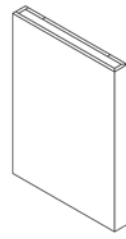

PILLAR BASE CABINET  
CODE SIZE mm (W)  
75-BS\_PILLAR-16 75



SINGLE SHUTTER PULL-OUT BASE CABINET  
CODE SIZE mm (W)  
150-BS1\_002-FO\_7S 150

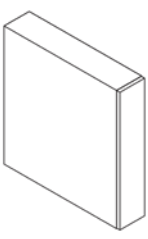

PILLAR BASE CABINET  
CODE SIZE mm (W)  
150-BS\_PILLAR-FO\_7S 150

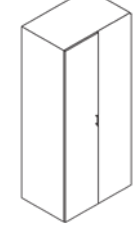

SINGLE SHUTTER TALL CABINET  
CODE SIZE mm (W)  
1135-TC1\_SL\_A450\_N 1135

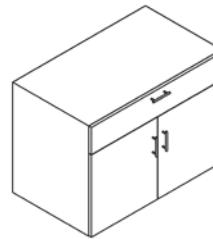

SINGLE DRAWER DOUBLE SHUTTER SINK  
BASE CABINET  
CODE SIZE mm (W)  
SI2\_1D-FO\_7S 800, 900, 1000, 1200

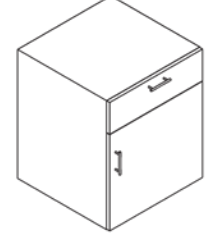

SINGLE DRAWER AND SHUTTER SINK  
BASE CABINET  
CODE SIZE mm (W)  
BS1\_A-FO\_7S 500, 600

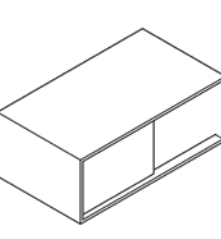

SLIDING BASE CABINET  
CODE SIZE mm (W)  
BS2\_SLID-FO\_7S 800, 1000, 1200

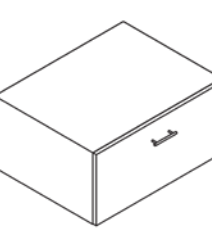

HANGING TANDEM BOX BASE CABINET  
CODE SIZE mm (W)  
BS\_1TB\_HANG-FO\_7S 600, 750, 800  
900, 1000

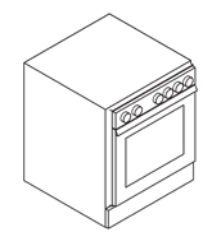

OVEN BASE CABINET  
CODE SIZE mm (W)  
OC\_60-FO\_7S 600  
OC\_90-FO\_7S

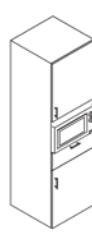

DOUBLE SHUTTER SINGLE DRAWER  
MICROWAVE TALL CABINET  
CODE SIZE mm (W)  
600-T03\_1-FO\_7S 600

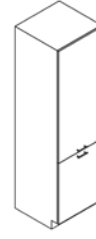

DOUBLE SHUTTER FRIDGE TALL CABINET  
CODE SIZE mm (W)  
600-TO\_FRIDGE\_PB-FO\_7S 600

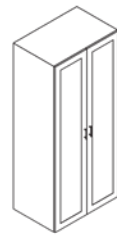

DOUBLE SHUTTER GLAZED TALL CABINET  
CODE SIZE mm (W)  
1235-TC1\_G2-FO\_7S 1235

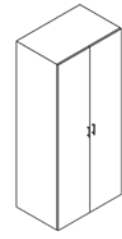

DOUBLE SHUTTER TALL CABINET  
CODE Size mm (W)  
900-TG2\_650A\_N 900

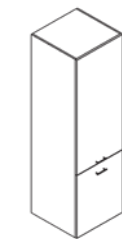

DOUBLE SHUTTER SOLID TALL CABINET  
CODE SIZE mm (W)  
600-TS2\_N-203-WA 600

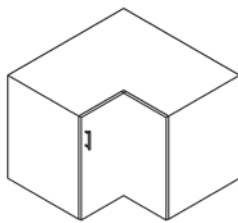

BI FOLD BASE CABINET  
CODE SIZE mm (W)  
935-BC2\_S-FO\_7S 935

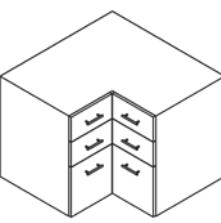

CORNER SPACE DRAWER BASE CABINET  
CODE SIZE mm (W)  
BS-BLUM-FO\_7S 935

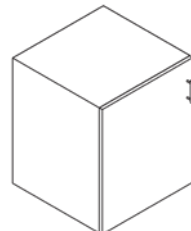

SINGLE SHUTTER BASE CABINET  
CODE SIZE mm (W)  
BS1\_M-FO\_7S 300, 400, 450, 500, 600

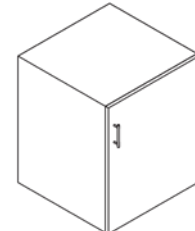

SINGLE SHUTTER SINK BASE CABINET  
CODE SIZE mm (W)  
600-SU1\_MP-FO\_7S 600

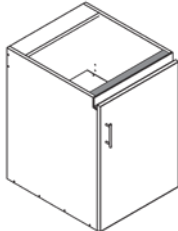

SINGLE SHUTTER BASE CABINET  
CODE SIZE mm (W)  
BS1\_060B-EG\_ST9 400, 450, 500, 600

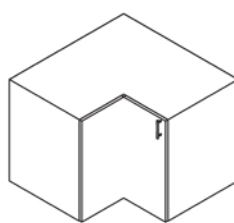

BI FOLD SINK BASE CABINET  
CODE SIZE mm (W)  
935-SI\_C2\_S\_MP-FO\_7S 935

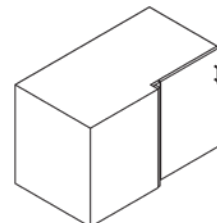

CORNER SINK BASE CABINET LEFT  
CODE SIZE mm (W)  
1135-SC1\_S-FO\_7S 1135

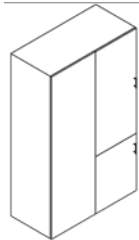

DOUBLE SHUTTER TALL CORNER CABINET  
CODE 1135-TCL\_SL\_A450-FO\_7S  
SIZE mm (W) 1135



MEDIUM HEIGHT DOUBLE DRAWER  
TALL CABINET  
CODE 600-TO1\_OVEN\_2B-FO\_7S  
SIZE mm (W) 600

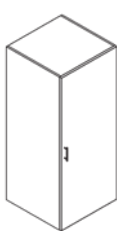

TALL CABINET MEDIUM HEIGHT SINGLE SHUTTER  
WITH STORAGE  
CODE 600-MT\_S2\_1440-FO\_7S  
SIZE mm (W) 600



SINGLE SHUTTER GLAZED TALL CABINET  
CODE TG5\_990-FO\_7S  
SIZE mm (W) 600



SINGLE SHUTTER SOLID TALL CABINET  
CODE MTR\_A230B\_2000-FO\_7S  
SIZE mm (W) 600

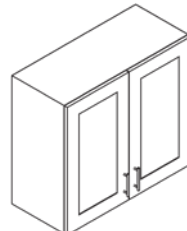

DOUBLE SHUTTER GLAZED  
WALL CABINET  
CODE WG2\_1290-FO\_7S  
SIZE mm (W) 800, 900, 1000, 1200

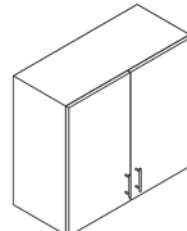

DOUBLE SHUTTER SOLID  
WALL CABINET  
CODE WS2\_600-FO\_7S  
SIZE mm (W) 800, 900, 1000, 1200

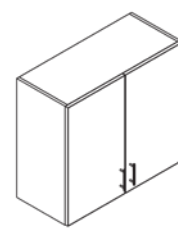

DOUBLE SHUTTER SOLID VOGUE  
WALL CABINET  
CODE WS2\_720-FO\_7S  
SIZE mm (W) 800, 900, 1000, 1200  
WS2\_960-FO\_7S



TRIPPLE SHUTTER WALL CABINET  
CODE 600-WS1\_1800\_3-FO\_7S  
SIZE mm (W) 1800

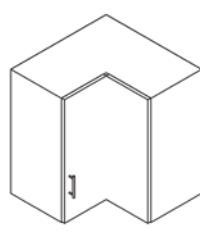

CORNER BI FOLD SOLID WALL CABINET  
CODE 635-WC\_S-FO\_7S  
SIZE mm (W) 635



DOUBLE SHUTTER OVEN TALL CABINET  
CODE 600-TO4\_OVEN\_60-FO\_7S  
SIZE mm (W) 600



DOUBLE SHUTTER SINGLE DRAWER  
TALL CABINET  
CODE 600-TO5-FO\_7S  
SIZE mm (W) 600



SINGLE SHUTTER & DRAWER  
MICROWAVE & OVEN TALL CABINET  
CODE 600-TO3\_1\_N  
SIZE mm (W) 600

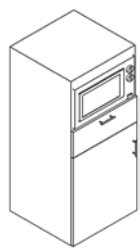

OPEN ONE PARTITION TALL CABINET  
CODE 600-TO1\_MC-FO\_7S  
SIZE mm (W) 600

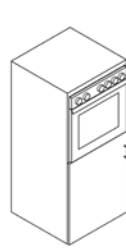

SINGLE SHUTTER OVEN TALL CABINET  
CODE 600-TO1\_OVEN-FO\_7S  
SIZE mm (W) 600

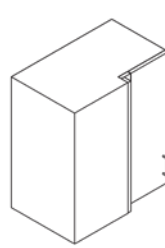

CORNER WALL CABINET LEFT  
CODE 635-WC1\_S-FO\_7S  
SIZE mm (W) 635



WALL END OPEN OPERA  
CODE WOC\_1200-203-WA  
SIZE mm (W) 1200

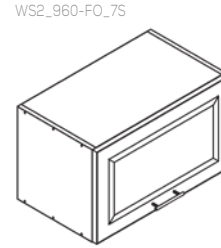

GLAZED FLAP WALL CABINET  
CODE WF1\_PL\_S\_360-FO\_7S  
SIZE mm (W) 600, 800, 900, 1000, 1200

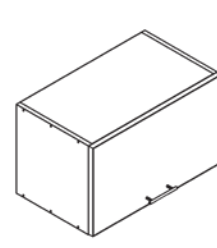

SOLID FLAP WALL CABINET  
CODE WF1\_SF\_S\_610-FO\_7S  
SIZE mm (W) 600, 800, 900, 1000, 1200

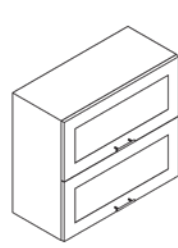

DOUBLE SHUTTER FLAP GALZED  
WALL CABINET  
CODE WF2\_DF\_G\_720-FO\_7S  
SIZE mm (W) 600, 800, 900, 1000, 1200



OPEN STRIP TALL CABINET LEFT MINIMAL  
CODE 300-TOC\_2140-15-B0  
SIZE mm (W) 300



OPEN STRIP TALL CABINET LEFT VOGUE  
CODE 300-TOC\_2140-15-WA  
SIZE mm (W) 300



OPEN TALL CABINET PAINTED FRAME BROOKLYN  
CODE 600-TOC\_P\_2205  
SIZE mm (W) 300, 600



OPEN TALL CABINET PAINTED FRAME SOHO  
CODE 600-TOC\_P\_2205  
SIZE mm (W) 300, 600



SINGLE SHUTTER WITH PULL-OUT MECHANISM  
TALL CABINET  
CODE 450-TS1\_250-FO\_7S  
SIZE mm (W) 450

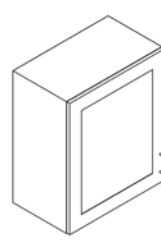

SINGLE SHUTTER GLAZED WALL CABINET  
CODE WG1\_600-FO\_7S  
SIZE mm (W) 400, 450, 500, 600

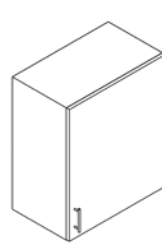

SINGLE SHUTTER SOLID WALL CABINET  
CODE WS1\_600-FO\_7S  
SIZE mm (W) 400, 450, 500, 600

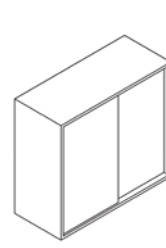

SLIDING GLAZED WALL CABINET  
CODE WG2\_SLID\_600-FO\_7S  
SIZE mm (W) 800, 900, 1000, 1200

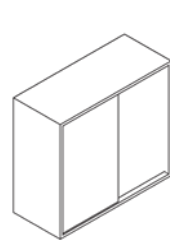

SLIDING SOLID WALL CABINET  
CODE WS2\_SLID\_600-FO\_7S  
SIZE mm (W) 800, 900, 1000, 1200



OPEN WALL UNIT SPICE RACK  
CODE WOC-SR-1290  
Size mm (W) 600



PILLAR TALL CABINET  
CODE 75-TL\_PILLAR-14  
SIZE mm (W) 75



PILLAR TALL CABINET  
CODE 75-TL\_PILLAR-16  
SIZE mm (W) 75

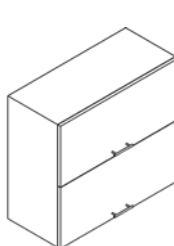

DOUBLE SHUTTER FLAP SOLID  
HOOD WALL CABINET  
CODE F2\_S\_H\_720-FO\_7S  
SIZE mm (W) 600, 800, 900, 1000, 1200

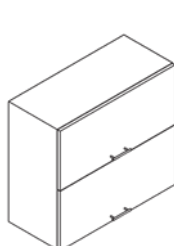

DOUBLE SHUTTER FLAP SOLID  
WALL CABINET  
CODE WF2\_S\_600-FO\_7S  
SIZE mm (W) 600, 800, 900, 1000, 1200

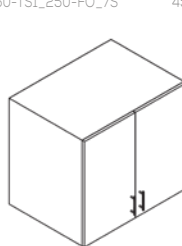

DOUBLE SHUTTER  
WALL CABINET  
CODE WS2\_600-FO\_7S  
SIZE mm (W) 600, 900, 1000, 1200  
WS2\_720-FO\_7S  
WS2\_960-FO\_7S

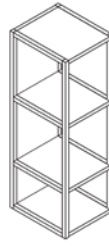

OPEN WALL CABINET BROOKLYN  
CODE WOC\_P  
SIZE mm (W) 300, 600



TWO SHELF OPEN WALL CABINET  
CODE WOC\_1080-FO\_7S  
SIZE mm (W) 300, 400, 450, 500, 600

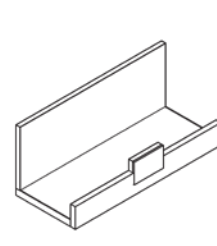

HANGING SHELF WALL CABINET OPERA  
CODE WSH\_HNG\_V\_N-203-  
SIZE mm (W) 450, 500, 600, 800, 900, 1000, 1200  
WA

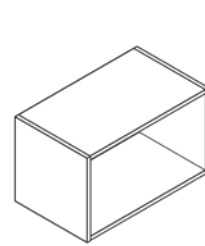

OPEN WALL CABINET  
CODE WOC\_360-FO\_7S  
SIZE mm (W) 300, 400, 450, 500, 600, 800, 900

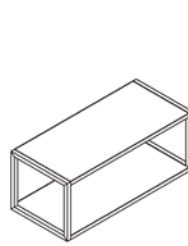

OPEN WALL CABINET  
CODE 300-WOC\_M  
SIZE mm (W) 300, 400, 450, 500, 600, 800, 900



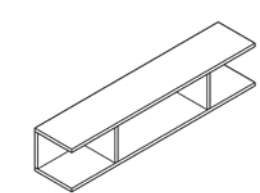

OPEN WALL CABINET WITHOUT FRAME VOGUE  
CODE WOC\_WF\_240-15-BO  
SIZE mm (W) 600, 900, 1200

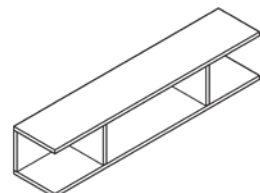

OPEN WALL CABINET WITHOUT FRAME  
CODE WOC\_WF\_240-17-WA  
SIZE mm (W) 600, 900, 1200

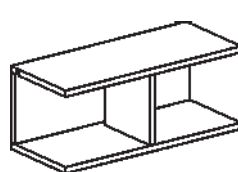

OPEN WALL UNIT WITHOUT FRAME  
CODE 600-WOC\_WF\_240-17-WA  
Size mm (W) 600

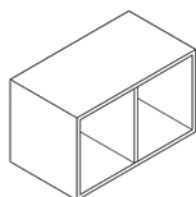

OPEN ONE PARTITION WALL CABINET  
CODE WOC\_360\_1P-FO\_7S  
SIZE mm (W) 900, 1200

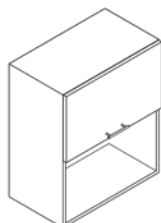

OPEN SOLID FLAP WALL CABINET  
CODE WFL\_PL\_S\_720-FO\_7S  
SIZE mm (W) 600, 800, 900, 1000, 1200



PILLAR WALL CABINET  
CODE 15-TL\_PILLAR-MI\_277  
SIZE mm (W) 150

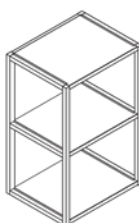

OPEN WALL CABINET PAINTED FRAME SOHO  
CODE 300-WOC\_P  
SIZE mm (W) 300, 600



OPEN SHELF  
CODE 337-WOP\_CB-FO\_7S  
SIZE mm (W) 300, 400, 450, 500, 600



OPEN SHELF WITHOUT TOP  
CODE WOC\_720-FO\_7S  
SIZE mm (W) 300, 400, 450, 500, 600

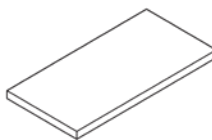

SOHO TOP  
CODE 1800-ISL-900-14-OK  
SIZE mm (W) 600, 800, 900, 1200

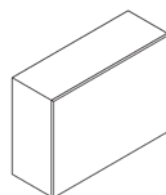

WALL CABINET HOOD  
CODE 600-HOOD\_360-FO\_7S  
SIZE mm (W) 600, 800, 900, 1000, 1200

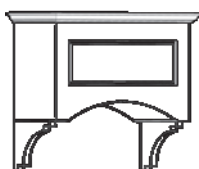

WALL CABINET HOOD (CLAIRE)  
CODE HOOD-1040-12-JA  
Size mm (W) 1140

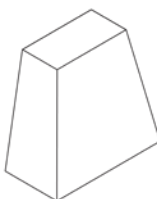

WALL CABINET HOOD SOHO  
CODE 900-HOOD\_800-14  
SIZE mm (W) 900

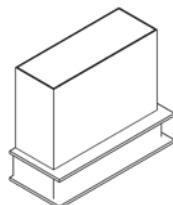

WALL CABINET HOOD BROOKLYN  
CODE 1000-HOOD\_840-16  
SIZE mm (W) 600, 800, 900, 1000, 1200

## TALL CABINET PERMUTATIONS

2040 / 2280 mm

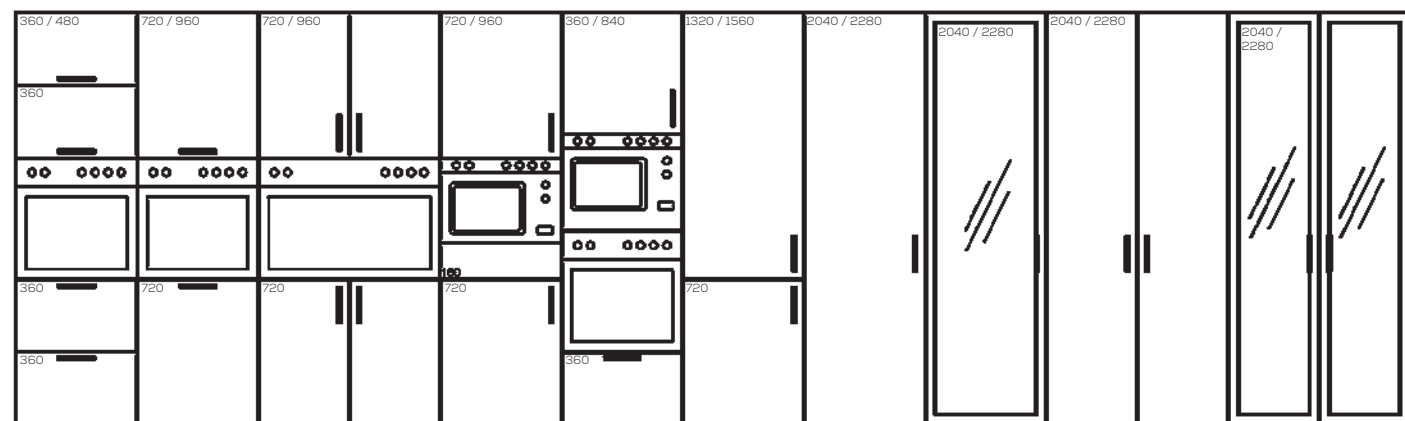

## MEDIUM HEIGHT TALL CABINET PERMUTATIONS

1338 mm

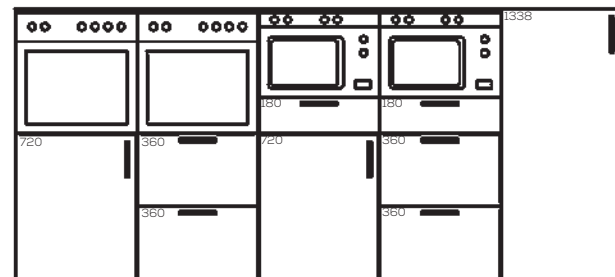

## BASE CABINET PERMUTATIONS

720 mm

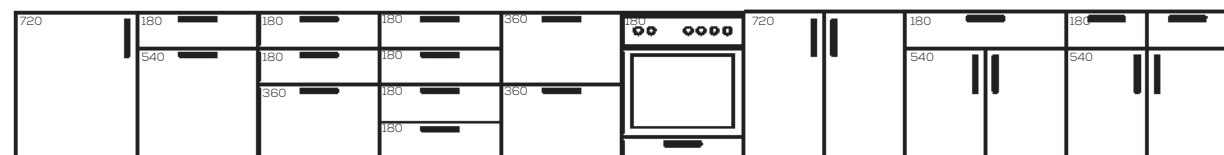

## WALL CABINET PERMUTATIONS

600 / 720 / 960 mm

